



LCTC ENGINEERING AND ARCHITETURE CLASSROOM

DESIGN DEVELOPMENT | 02.03.24

**interior
environments**



YOUR DEDICATED TEAM

Our team of specialists were hired based on technical skillsets to create spaces that encompass innovative, unique and creative solutions.



Steve Cojei

President
Co-Founder

248.921.1700 | scojei@ieoffices.com



Bari Pfeiffer

Account Manager

248.635.7908 | bpfeiffer@ieoffices.com



Becky Gusoff

Senior Project Designer

734.673.0546 | bgusoff@ieoffices.com



Betsy Pethoud

Account Manager

248.996.6270 | bpethoud@ieoffices.com



Sierra Wolf

Project Designer

248.996.6221 | swolf@ieoffices.com



Lisa Costella

Project Designer

248.301.1972 | lcostella@ieoffices.com



Alicia Mahone

Project Coordinator

248.305.1942 | amahone@ieoffices.com



Andrew Veidenheimer

Field Project Manager

203.273.7806 | aveidenheimer@ieoffices.com

DESIGN DEVELOPMENT
CLASSROOM LAYOUT

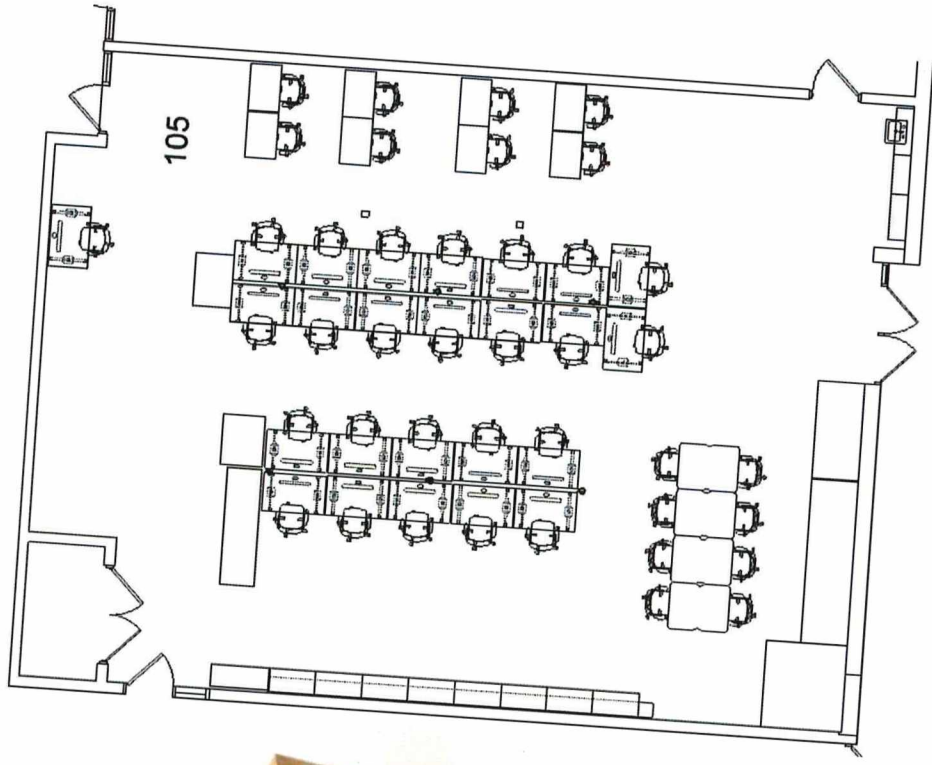
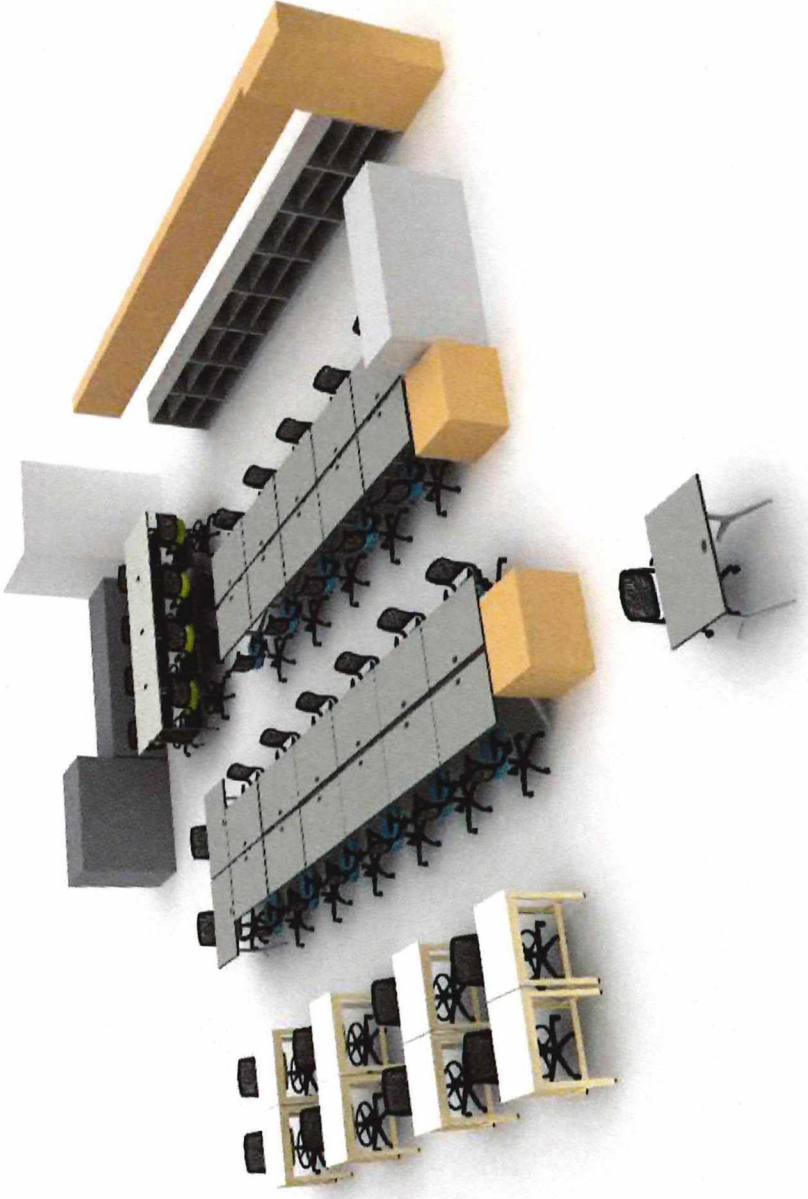

DESIGN DEVELOPMENT

DRAFTING TABLES



DRAFTING TABLE CAFÉ HEIGHT
MOTIVATE CAFÉ HEIGHT STOOL



ADJUSTABLE TOP
*LARGE DRAWER SHOWN BUT
SMALL DRAWER IS SPECIFIED

DESIGN DEVELOPMENT

PRODUCT SELECTIONS



SEATING HEIGHT TABLE
MOTIVATE CHAIR



MAKERSPACE TABLE WITH SHELVES
MOTIVATE CAFÉ HEIGHT STOOL



3H BOOKCASE

interior environments

DESCRIPTION	QTY	UNIT PRICING	EXTENDED PRICING
Aware 30"D x 48"W Seated Height Desk	25	\$ 608.44	\$ 15,211.00
Motivate Task Chair	25	\$ 394.15	\$ 9,853.75
Drafting Table, 24"D x 36"W x 36"H	8	\$ 1,013.50	\$ 8,108.00
Makerspace Table 46"D x 36"W x 39"H	4	\$ 964.10	\$ 3,856.40
Motivate Task Stool	16	\$ 431.98	\$ 6,911.68
Essential 3H Bookcases	8	\$ 474.12	\$ 3,792.96
Sub-Total:			\$ 47,733.79
		FURNITURE SUB-TOTAL	\$ 47,733.79
		CONTINGENCY	\$ 4,773.38
		FREIGHT	\$ 751.35
		LABOR - REMOVAL OF EXISTING	\$ 2,100.00
		LABOR - INSTALLATION OF NEW	\$ 5,200.00
		GRAND TOTAL	\$ 60,558.52

Create space.



Thank you for choosing CDW. We have received your quote.

Hardware Software Services IT Solutions Brands Research Hub

QUOTE CONFIRMATION

KEVIN ZIMES,

Thank you for considering CDW•G for your technology needs. The details of your quote are below. **If you are an eProcurement or single sign on customer, please log into your system to access the CDW site.** You can search for your quote to retrieve and transfer back into your system for processing.

For all other customers, click below to convert your quote to an order.

Convert Quote to Order

ACCOUNT MANAGER NOTES: Please inspect all product within 15 days of delivery. CDW has a strict 15 day return policy for anything damaged, and a 30 day return policy on standard product.

Thank you!

Wes
877.874.9063

QUOTE #	QUOTE DATE	QUOTE REFERENCE	CUSTOMER #	GRAND TOTAL
PGMZ063	1/15/2025	HP CAD	1271134	\$57,475.08

QUOTE DETAILS

ITEM	QTY	CDW#	UNIT PRICE	EXT. PRICE
HP Z2 Mini G9 Workstation - Intel Core i7 14th Gen i7-14700 - 16 GB - 512 G Mfg. Part#: A12LCUT#ABA Contract: REMC Computers 2024 (REMC COMP 2024)	26	7852879	\$1,550.00	\$40,300.00
HP P34HC G4 34" Class WQHD Curved Screen LCD Monitor - 21 9 - Black Mfg. Part#: 21Y56AA#ABA Contract: REMC Technology & Furniture 2025 (01)	26	6416139	\$500.00	\$13,000.00
HP USB Business Slim Smartcard Keyboard Mfg. Part#: Z9H48AA#ABA UNSPSC: 43211706 Contract: REMC Computers 2024 (REMC COMP 2024)	26	4462700	\$58.25	\$1,514.50
3Dconnexion CadMouse Pro Mfg. Part#: 3DX-700080 Contract: REMC Technology & Furniture 2025 (01)	26	6436068	\$102.33	\$2,660.58

SUBTOTAL	\$57,475.08
SHIPPING	\$0.00
SALES TAX	\$0.00
GRAND TOTAL	\$57,475.08

PURCHASER BILLING INFO	DELIVER TO
Billing Address: LIVONIA PUBLIC SCHOOLS ACCTS PAYABLE 15125 FARMINGTON RD LIVONIA, MI 48154-5474 Phone: (734) 523-9164 Payment Terms: NET 30-VERBAL	Shipping Address: LIVONIA PUBLIC SCHOOLS KEVIN ZIMES 15125 FARMINGTON RD LIVONIA, MI 48154-5474 Phone: (555) 555-5555 Shipping Method: FEDEX Ground
	Please remit payments to: CDW Government 75 Remittance Drive Suite 1515 Chicago, IL 60675-1515



Sales Contact Info

Wes Farrell | (877) 874-9063 | wesfar@cdw.com

Need Help?



My Account



Support



Call 800.800.4239

[About Us](#) | [Privacy Policy](#) | [Terms and Conditions](#)

This order is subject to CDW's Terms and Conditions of Sales and Service Projects at <http://www.cdw.com/content/terms-conditions/product-sales.aspx>

For more information, contact a CDW account manager.

© 2025 CDW•G LLC, 200 N. Milwaukee Avenue, Vernon Hills, IL 60061 | 800.808.4239