

DATE: \_\_\_\_\_  
AUTHORIZED SIGNATURE: \_\_\_\_\_  
SIGNATURE'S NAME: \_\_\_\_\_

SERVICE PLAN  
3/16" = 1'-0" (24" X 36")

**Disclaimer**  
The drawings provided herein depict approximate measurement for placement of cabinets and equipment. Snap-on makes no representations or warranties relative to compliance with any building code requirements. Qualified architects, engineers, general contractors and construction consultants should be retained by the building owner and/or occupant prior to finalizing any construction plans.  
  
In no event shall Snap-on, or its parent company(s), be liable for any special, indirect or consequential damages (including, without limitation, lost profits, revenues, anticipated sales, business opportunities or goodwill; interruption of business; or loss of business information) resulting from or arising out of reliance upon these drawings, even if it has been advised of the possibility of such damages.

BUILD-A-BAY EQUIPMENT PLAN  
FOR  
BALL HIGH SCHOOL NEW SHOP  
XX

DATE:  
11/4/2025 2:13 PM  
DRAWN:  
ALR  
REVIEWED:  
-  
PROJECT NO:  
25\_80\_064458  
DRAWING NO:  
BAB-1.0

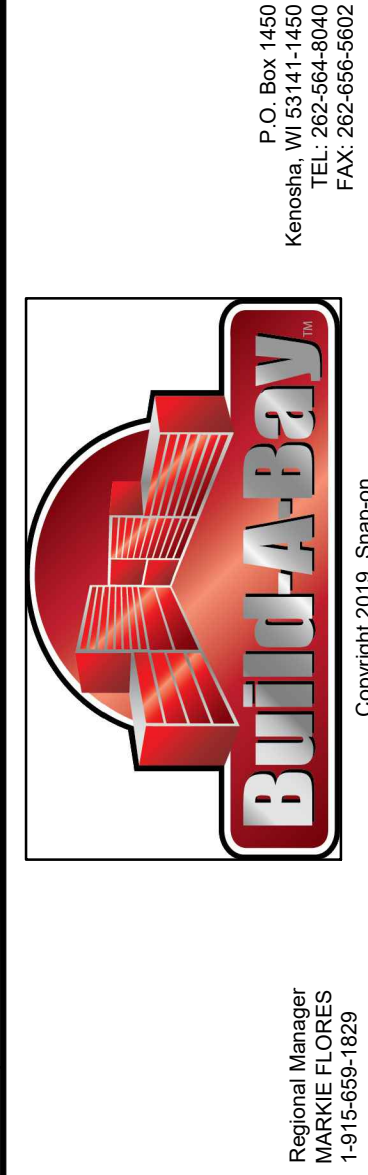



Ball High School New Shop  
AutoShop Lab  
BAB 064458

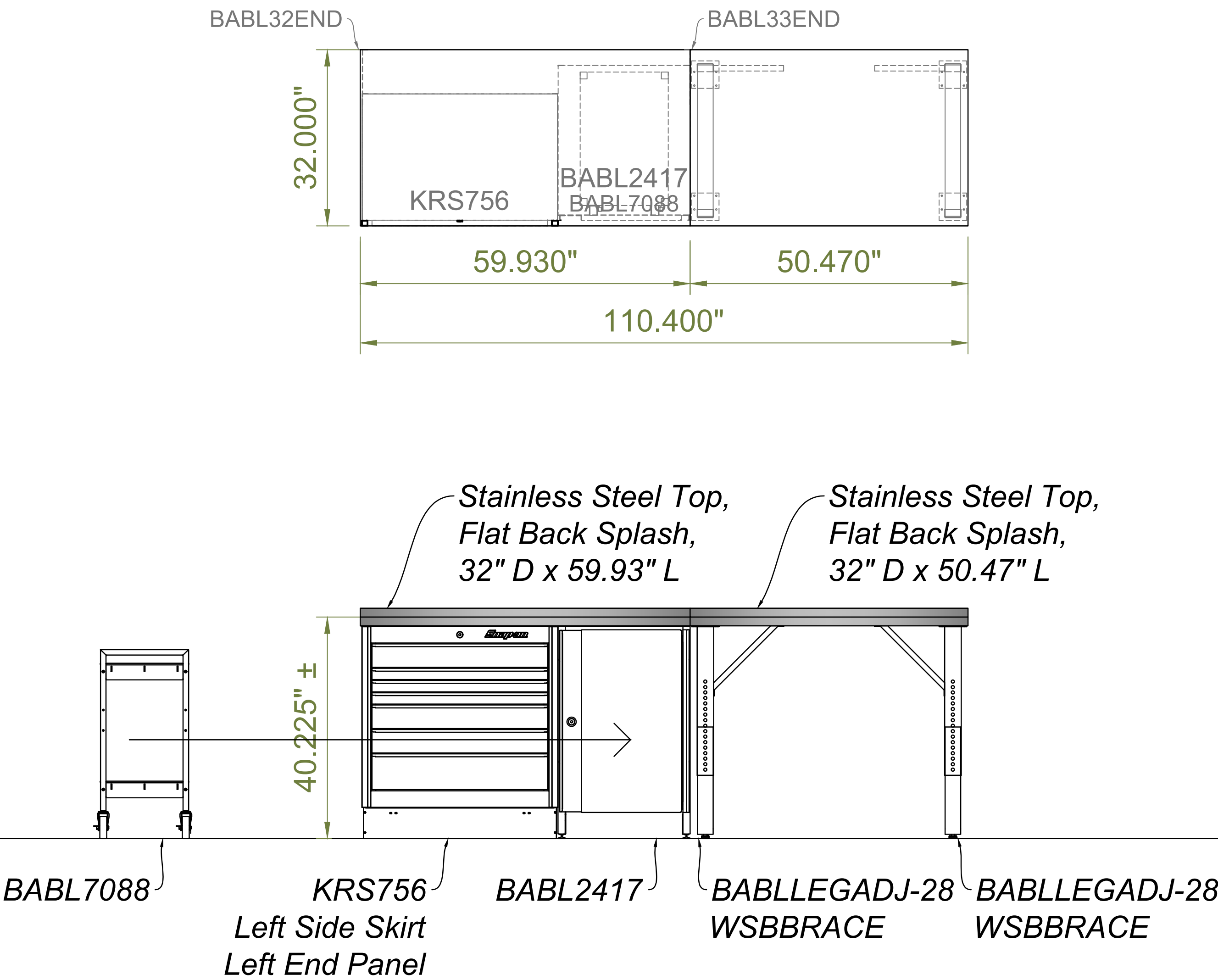

**A = 5 Units**  
**Color:** \_\_\_\_\_ **Initial:** \_\_\_\_\_ **Date:** \_\_\_\_\_

- Each Unit Consists:
- (1) Stainless Steel Top, Flat Back Splash, 32" D x 59.93" L
  - (1) Stainless Steel Top, Flat Back Splash, 32" D x 50.47" L
  - (1) KRS756 Tool Box, Single Bank, (7) Drawers, Levelers & Front Skirt, 24" D x 35.68" W x 38.58" H
  - (1) BABL2417 24" Under Counter Cart Port, Levelers
  - (1) BABL7088 Rolling Tech Cart
  - (2) BABLLEGADJ-28 Adjustable Height Bench Leg
  - (2) WSBBRACE 18" Bench Leg Brace
  - (1) BABL32END End Filler Panel
  - (1) BABL33END End Filler Panel
  - (1) BABL28KPS Side Skirt

DRAFT

DATE: \_\_\_\_\_  
AUTHORIZED SIGNATURE: \_\_\_\_\_  
SIGNATURE'S NAME: \_\_\_\_\_

SERVICE PLAN  
3/4" = 1'-0" (24" X 36")

Disclaimer:  
The drawings provided herein depict approximate measurement for placement of cabinets and equipment. Snap-on makes no representations or warranties relative to compliance with any building code requirements. Qualified architects, engineers, general contractors and construction consultants should be retained by the building owner and/or occupant prior to finalizing any construction plans.

In no event shall Snap-on, or its parent company(s), be liable for any special, indirect or consequential damages (including, without limitation, lost profits, revenues, anticipated sales, business opportunities or goodwill; interruption of business; or loss of business information) resulting from or arising out of reliance upon these drawings, even if it has been advised of the possibility of such damages.

BUILD-A-BAY EQUIPMENT PLAN  
FOR  
BALL HIGH SCHOOL NEW SHOP  
XX

Ball High School New Shop  
Autoshop Storage  
BAB 064458

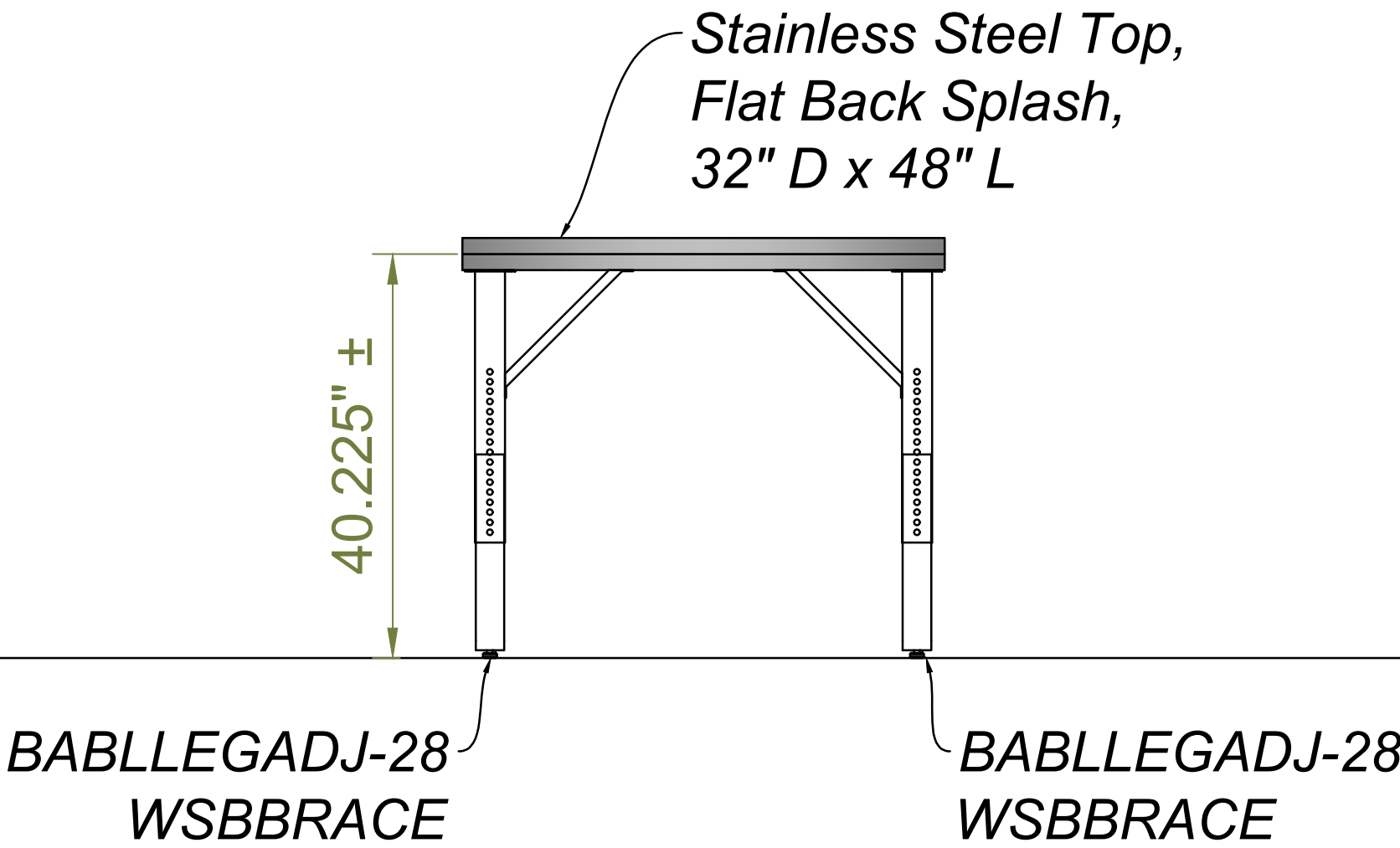
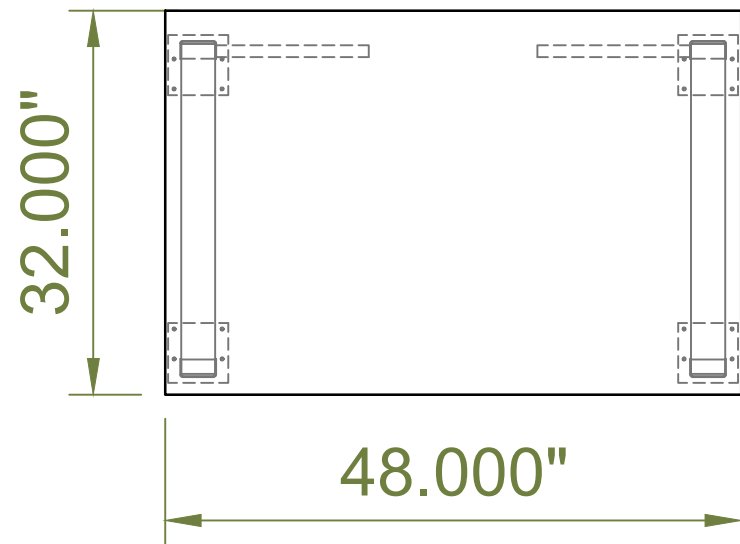

C = 6 Units  
Color: \_\_\_\_\_ Initial: \_\_\_\_\_ Date: \_\_\_\_\_

- Each Unit Consists:
- (1) Stainless Steel Top, Flat Back Splash, 32" D x 48" L
  - (2) BABLLEGADJ-28 Adjustable Height Bench Leg
  - (2) WSBBRACE 18" Bench Leg Brace

DATE: \_\_\_\_\_  
AUTHORIZED SIGNATURE: \_\_\_\_\_  
SIGNATURE'S NAME: \_\_\_\_\_

SERVICE PLAN  
3/4" = 1'-0" (24" X 36")

Disclaimer

The drawings provided herein depict approximate measurement for placement of cabinets and equipment. Snap-on makes no representations or warranties relative to compliance with any building code requirements. Qualified architects, engineers, general contractors and construction consultants should be retained by the building owner and/or occupant prior to finalizing any construction plans.

In no event shall Snap-on, or its parent company(s), be liable for any special, indirect or consequential damages (including, without limitation, lost profits, revenues, anticipated sales, business opportunities or goodwill; interruption of business; or loss of business information) resulting from or arising out of reliance upon these drawings, even if it has been advised of the possibility of such damages.



Regional Manager  
MARKIE FLORES  
1-815-659-1829

BUILD-A-BAY EQUIPMENT PLAN  
FOR  
BALL HIGH SCHOOL NEW SHOP  
XX

DATE:  
11/4/2025 2:13 PM  
DRAWN:  
ALR  
REVIEWED:  
-  
PROJECT NO:  
25\_80\_064458  
DRAWING NO:  
BAB-2.1

Ball High School New Shop  
Autoshop Storage  
BAB 064458

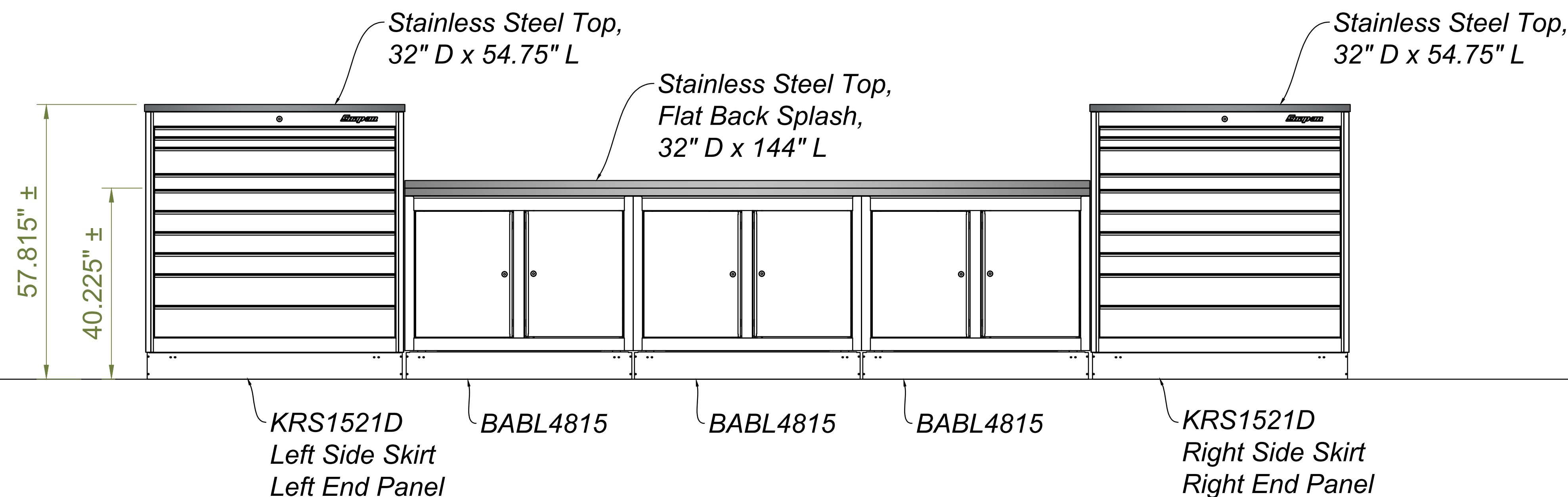
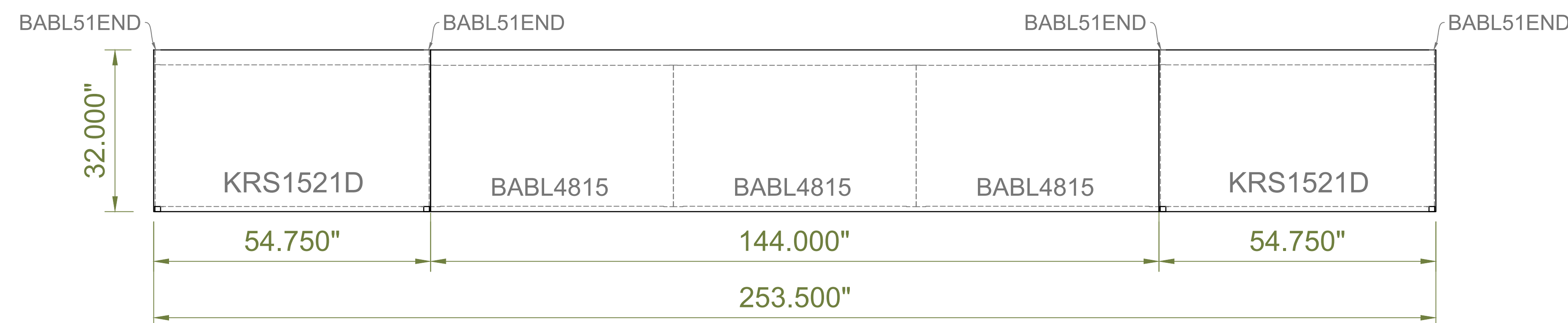

D = 1 Unit

Color: \_\_\_\_\_ Initial: \_\_\_\_\_ Date: \_\_\_\_\_

Each Unit Consists:

- (2) Stainless Steel Tops, No Back Splash, 32" D x 54.75" L
- (1) Stainless Steel Top, Flat Back Splash, 32" D x 144.0" L
- (3) BABL4815 48" Cabinet, Divided Double Door, (2) Adjustable Shelves, Levelers & Front Skirt
- (2) KRS1521D Tool Box, Single Bank, (10) Drawers, Levelers & Front Skirt, 54.25" W x 29" D x 56.375" H
- (1) KSSKRT29SET Side Skirt Set
- (4) BABL51END End Filler Panels

DATE: \_\_\_\_\_  
AUTHORIZED SIGNATURE: \_\_\_\_\_  
SIGNATURE'S NAME: \_\_\_\_\_

SERVICE PLAN  
3/4" = 1'-0" (24" X 36")

**DRAFT**

Disclaimer:  
The drawings provided herein depict approximate measurement for placement of cabinets and equipment. Snap-on makes no representations or warranties relative to compliance with any building code requirements. Qualified architects, engineers, general contractors and construction consultants should be retained by the building owner and/or occupant prior to finalizing any construction plans.

In no event shall Snap-on, or its parent company(s), be liable for any special, indirect or consequential damages (including, without limitation, lost profits, revenues, anticipated sales, business opportunities or goodwill; interruption of business; or loss of business information) resulting from or arising out of reliance upon these drawings, even if it has been advised of the possibility of such damages.

BUILD-A-BAY EQUIPMENT PLAN  
FOR  
BALL HIGH SCHOOL NEW SHOP  
XX

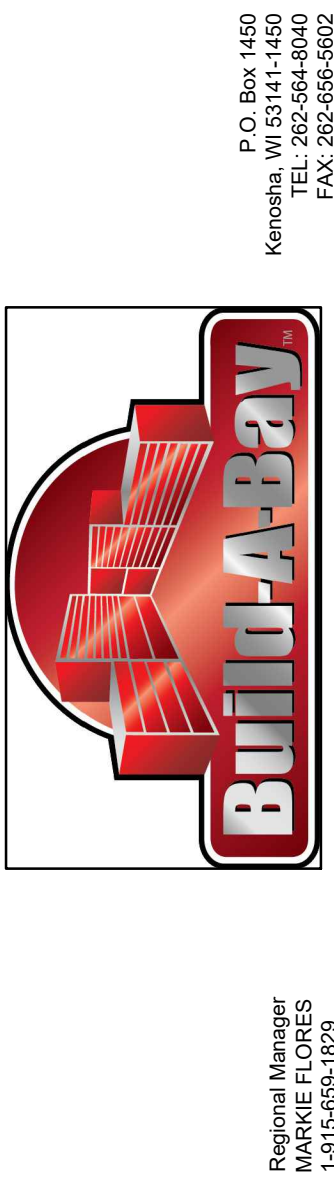



*Ball High School New Shop*  
*AutoShop Lab*  
*BAB 064458*

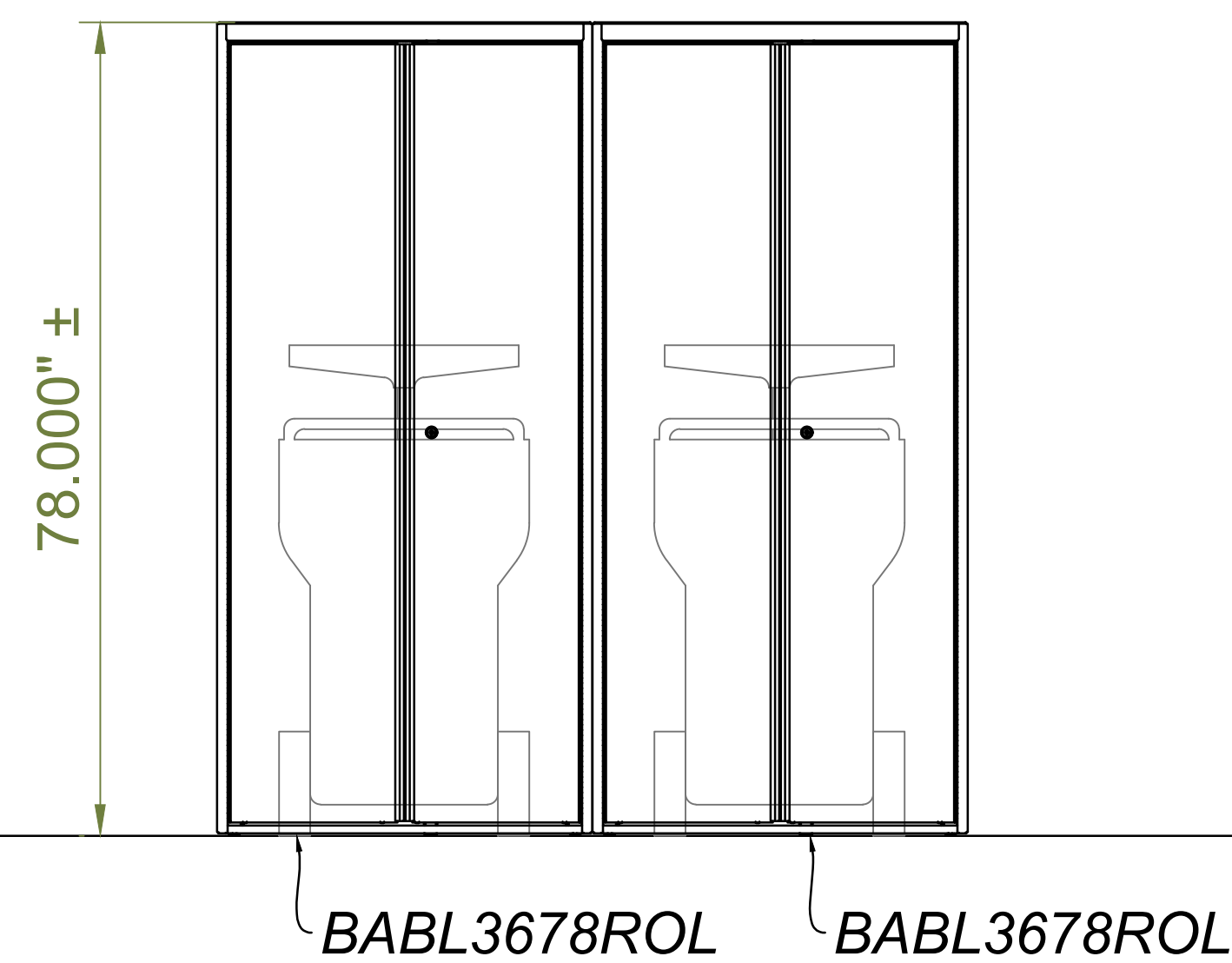
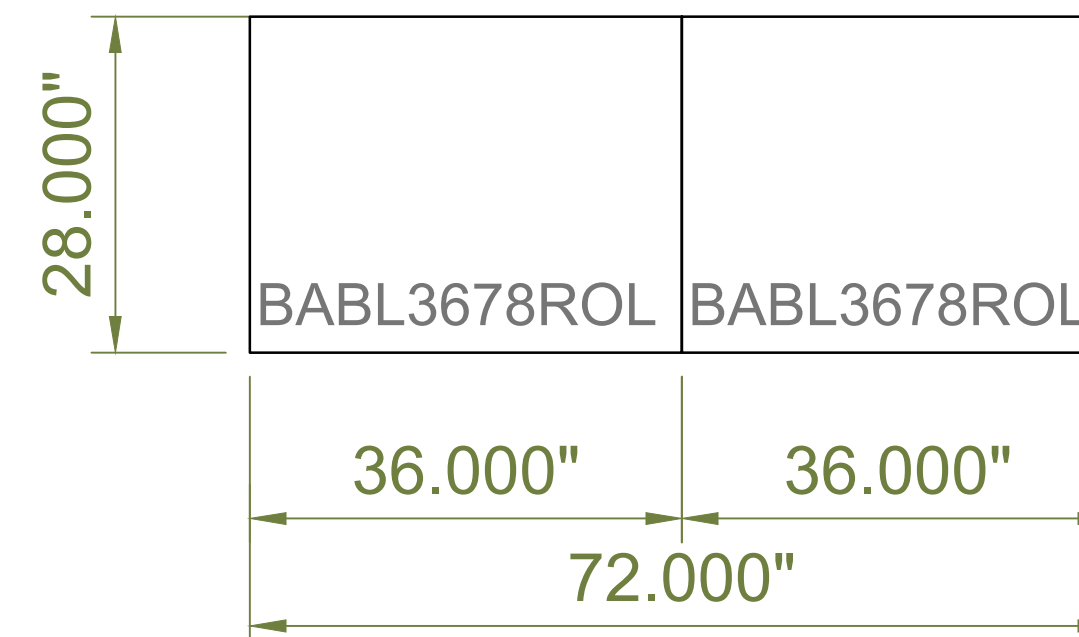

**E = 1 Unit**

**Color: \_\_\_\_\_ Initial: \_\_\_\_\_ Date: \_\_\_\_\_**

*Each Unit Consists:*  
*(2) BABL3678ROL 36" Tall Cabinet for*  
*Rolling Drains, (1) Adj Shelf, Levelers*

DATE: \_\_\_\_\_  
 AUTHORIZED SIGNATURE: \_\_\_\_\_  
 SIGNATURE'S NAME: \_\_\_\_\_

SERVICE PLAN  
3/4" = 1'-0" (24" X 36")

**Disclaimer**

The drawings provided herein depict approximate measurement for placement of cabinets and equipment. Snap-on makes no representations or warranties relative to compliance with any building code requirements. Qualified architects, engineers, general contractors and construction consultants should be retained by the building owner and/or occupant prior to finalizing any construction plans.

In no event shall Snap-on, or its parent company(s), be liable for any special, indirect or consequential damages (including, without limitation, lost profits, revenues, anticipated sales, business opportunities or good-will, interruption of business; or loss of business information) resulting from or arising out of reliance upon these drawings, even if it has been advised of the possibility of such damages.

BUILD-A-BAY EQUIPMENT PLAN  
FOR  
BALL HIGH SCHOOL NEW SHOP  
XX



**MARKIE FLORES**  
1-915-659-1829

TEL: 262-564-8040  
FAX: 262-656-5602