

# ADDITION TO WEST: 1-STORY 5 CLASSROOM PREVIOUSLY APPROVED DESIGN CONCEPT

EXISTING CLASSROOM COUNT:	AFTER ADDITION AND RENO:
GENERAL CLASSROOM (#): 22	26
KINDERGARTEN (K): 5	5
SPECIAL ED (SP): 2	2
<b>TOTAL:</b>	<b>33</b>

COLOR KEY:	NEW CONSTRUCTION AREA:	RENOVATION AREA:
<span style="background-color: #ADD8E6;">■</span> NEW CLASSROOM	5,000 SF	
<span style="background-color: #ADD8E6;">■</span> RENOVATED CLASSROOM		3,200 SF
<span style="background-color: #90EE90;">■</span> RENOVATED KINDERGARTEN CLASSROOM		
<span style="background-color: #FFDAB9;">■</span> RENOVATED ADMIN OFFICE		
<span style="background-color: #FFFF00;">■</span> NEW CORRIDOR	750 SF	200 SF
<span style="background-color: #D3D3D3;">■</span> NEW STORAGE OR OFFICE	200 SF	
<span style="background-color: #D3D3D3;">■</span> NEW TOILET		640 SF
<span style="background-color: #90EE90;">■</span> NEW ROOF GARDEN		
	<b>TOTAL AREA:</b> 5,950 SF	<b>4,040 SF</b>

**1-Story 5 Classroom Addition to WEST**

New construction:	\$2,261,000
Toilet Renovation:	\$160,000
Circulation link:	\$53,000
Renovated Classrooms (same scope as in currently approved project):	\$848,000
<b>Total:</b>	<b>\$2,474,000</b>

*Very rough numbers for Conversation Only*

**Cons:**

- Utility Relocation Required (gas (\$150,000), water, communications, and required concrete encasing of sewer line)
- Village Owned land

**Pros:**

- No impact of outdoor learning environment
- Provides 26 General Ed Classrooms and 5 Kindergarten Classrooms

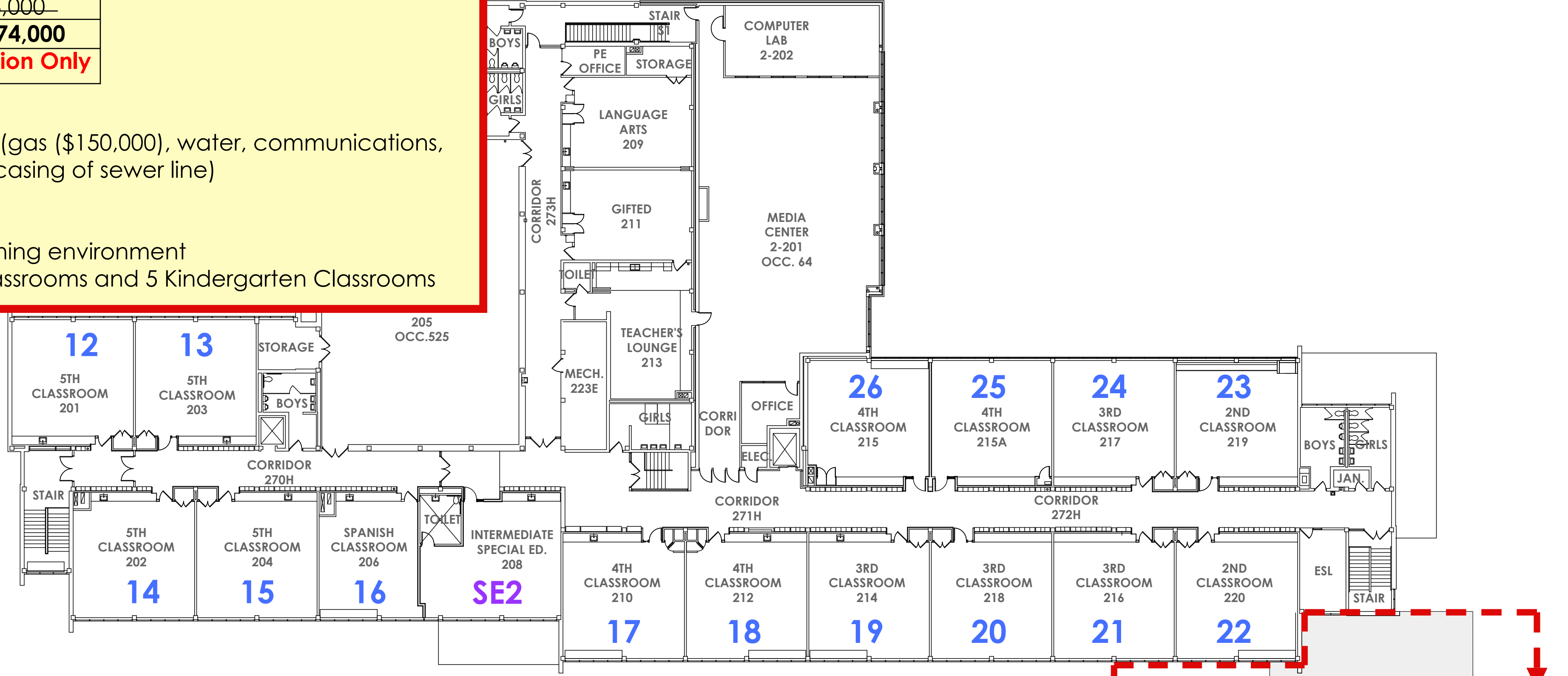

**SECOND FLOOR PLAN**

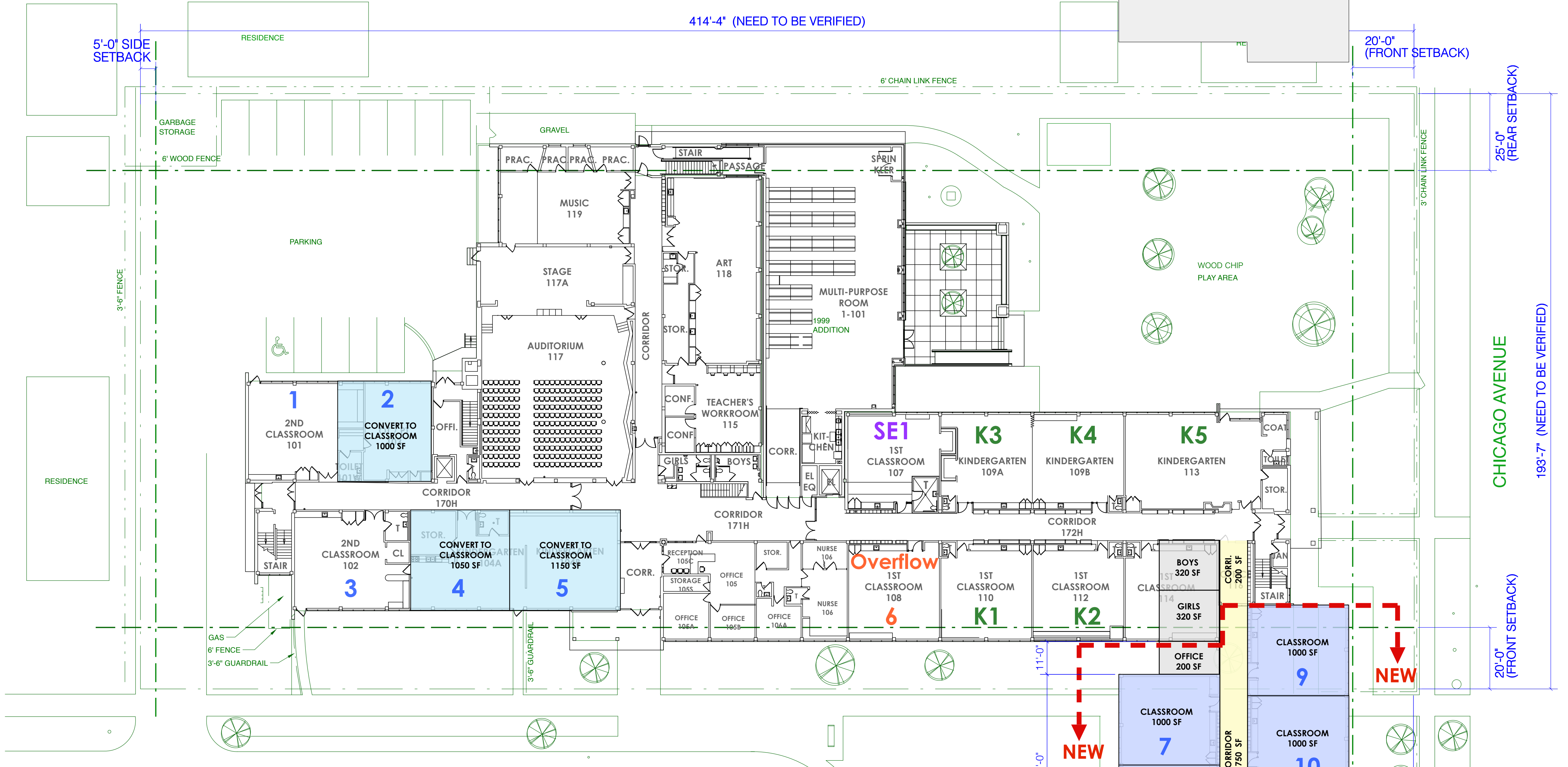

**FIRST FLOOR PLAN**

# OPT. 2