



2011-2012 Budget

Business Office
June 28, 2011



ISD 877 BHM 2011-2012 BUDGET OVERVIEW



- Required to have an approved budget prior to July 1st each year
- Financial plan used to help achieve our key objective

General Fund

**OPEB Debt
Service**

**Alternate
Facilities**

Food Service

**OPEB
Trust**

Debt Service

**Community
Service**

**Building
Construction**



ISD 877 BHM 2011-2012 BUDGET OVERVIEW



- Represents our best estimates of revenues and expenditures
- Based on School Board decisions
- Subject to revision



ISD 877 BHM 2011-2012 BUDGET PROCESS



- Starts in the fall with the levy process & enrollment projections
- Capital requests are sent to Buildings & Grounds
- Principals & dept. heads are given their supply budget allocations
- Salary projections are provided by Human Resources



GENERAL FUND



- Main operating fund
- Operating referendums

Gary

Tina

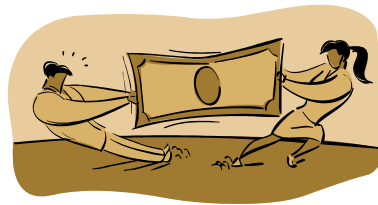

ISD 877 BHM 2011-2012 BUDGET ASSUMPTIONS



- General Fund
 - Revenues
 - 0% increase on the General Education Aid
 - Enrollment projection of 5,818 (ECSE-12)
 - Includes \$110 and \$379 operating referendums
 - Federal Ed Jobs bill in place for 2011-12



ISD 877 BHM 2011-2012 BUDGET ASSUMPTIONS



- General Fund (continued)
 - Expenditures
 - Superintendent & Special Ed staffing contingencies
 - Contract & benefits based on contracts & expected market conditions
 - Other expenditures (supplies & utilities) 0-5% increase
 - Continued cost containment initiatives
 - Integration program approved by MDE
 - Capital designation to be spent in 2011-12



ISD 877 BHM 2011-2012 BUDGET ASSUMPTIONS



- General Fund (continued)
 - Changes from Financial Forecast
 - Benefits number adjusted down for 0% health insurance increase and detailed review of actual costs for 10-11
 - Transportation and utility costs adjusted down to reflect less conservative view of costs
 - All day kindergarten shift of some expenditures to community service fund
 - Increased revenue projection from special ed due to more accurate MDE projections



ISD 877 BHM 2011-2012 GENERAL FUND



| | | |
|-----------------------------------|-----------------------|---------------------|
| Estimated Fund Balance @ 6/30/11* | | \$11,201,098 |
| Revenue | \$53,380,166 | |
| Expenditures | <u>(\$52,964,549)</u> | |
| Estimated Fund Balance @ 6/30/12* | | <u>\$11,616,715</u> |

**Fund Balance includes nonspendable, restricted, committed, assigned, and unassigned amounts*



ISD 877 BHM 2011-2012 GENERAL FUND



Unassigned Fund Balance Projection

| | 6/30/09 | 6/30/10 | 6/30/11 | 6/30/12 |
|--------------|--------------|--------------|--------------|--------------|
| Fund Balance | \$4,278,722 | \$6,151,513 | \$6,198,421 | \$7,647,097 |
| Expenditures | \$50,444,184 | \$59,821,245 | \$52,494,425 | \$52,964,549 |
| % of Exp. | 8.48% | 10.28% | 11.81% | 14.44% |



ISD 877 BHM 2011-2012 GENERAL FUND



Revenue

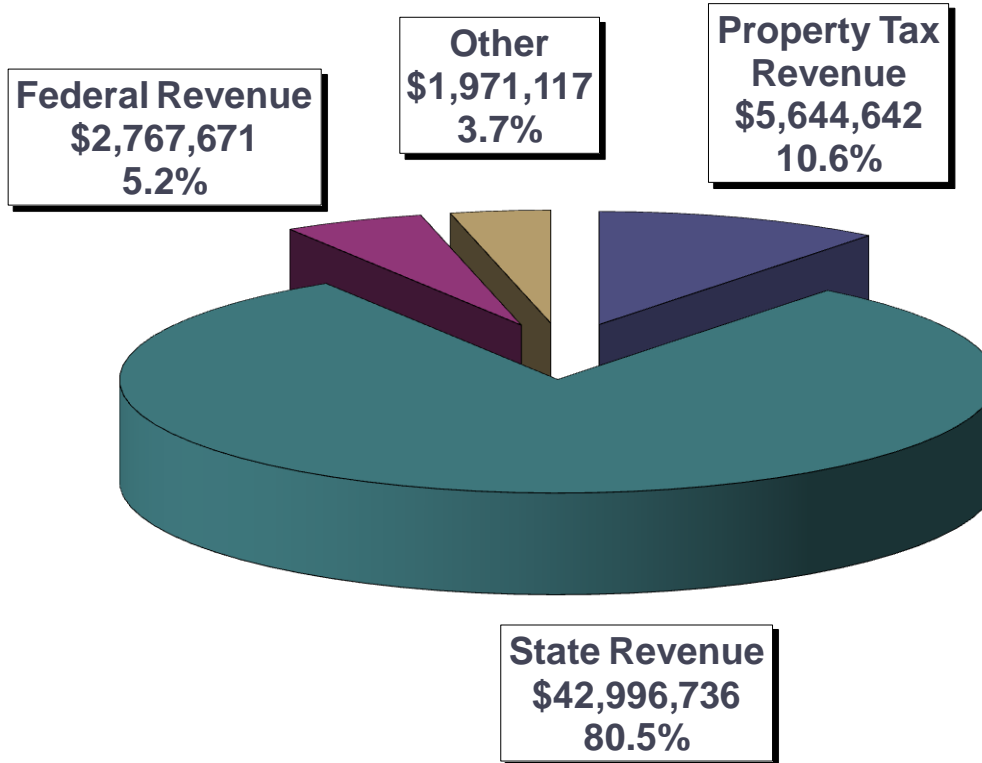

ISD 877 BHM 2011-2012 GENERAL FUND



Revenue (Excluding OPEB Bond)

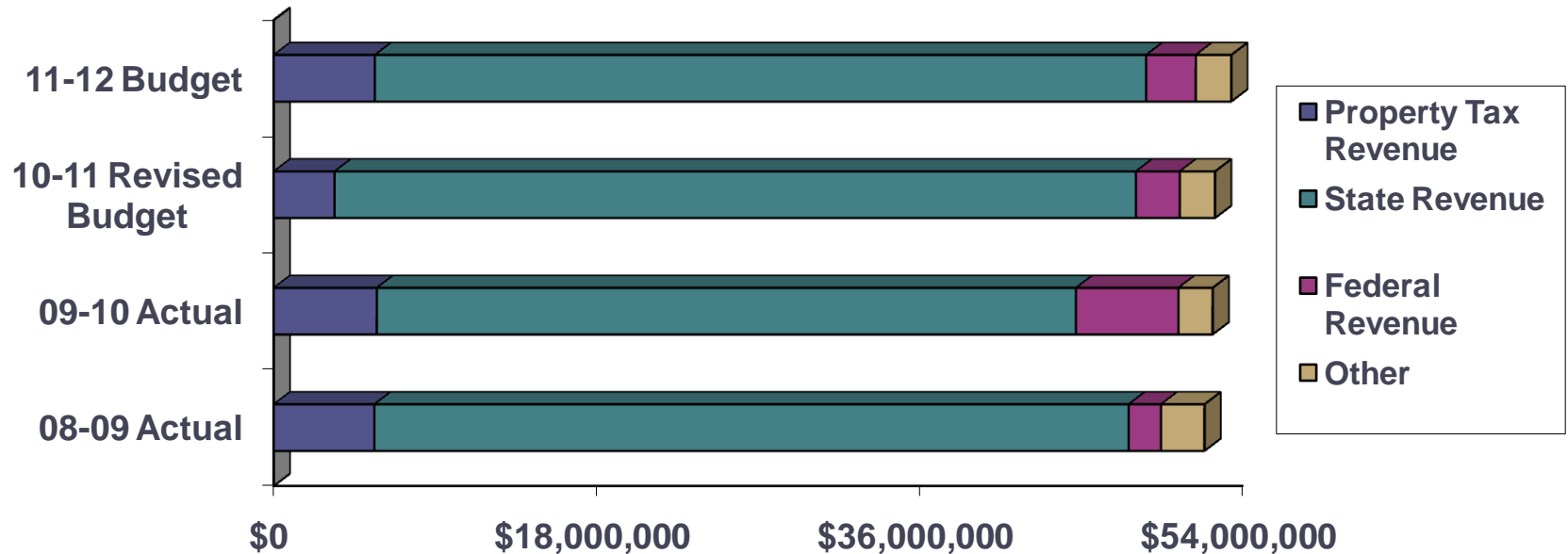

ISD 877 BHM 2011-2012 GENERAL FUND



Expenditures

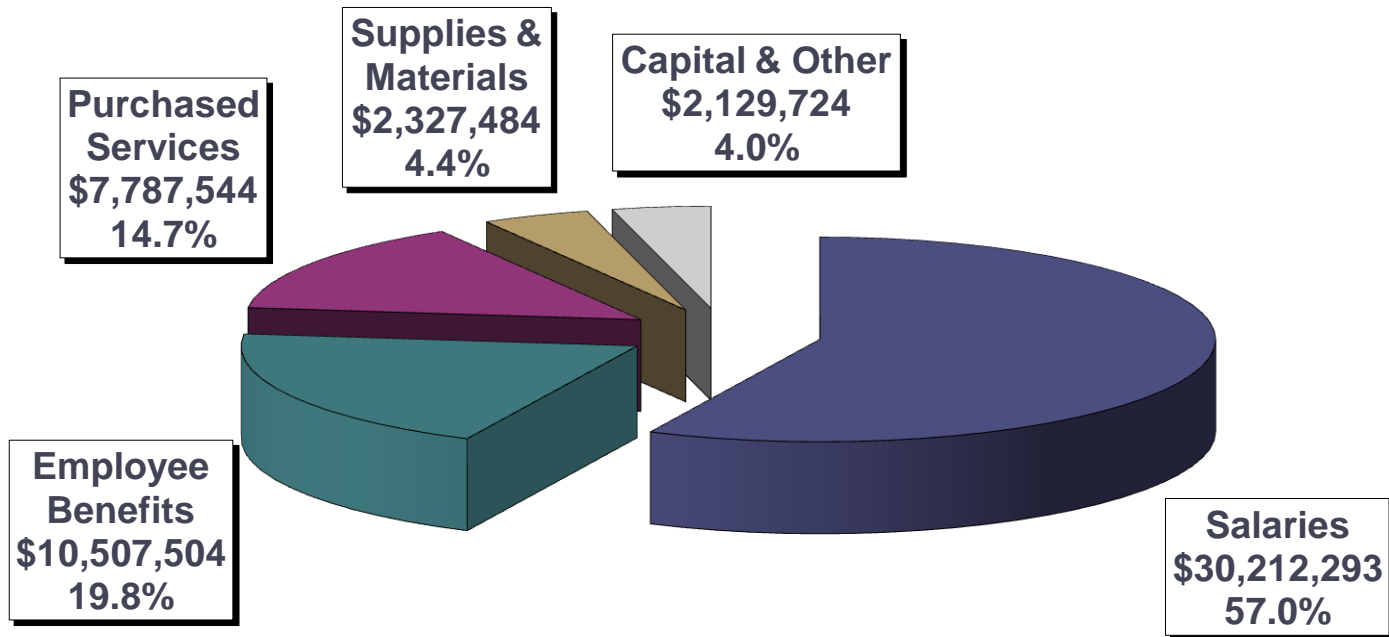

ISD 877 BHM 2011-2012 GENERAL FUND



Expenditures (Excluding OPEB Bond)

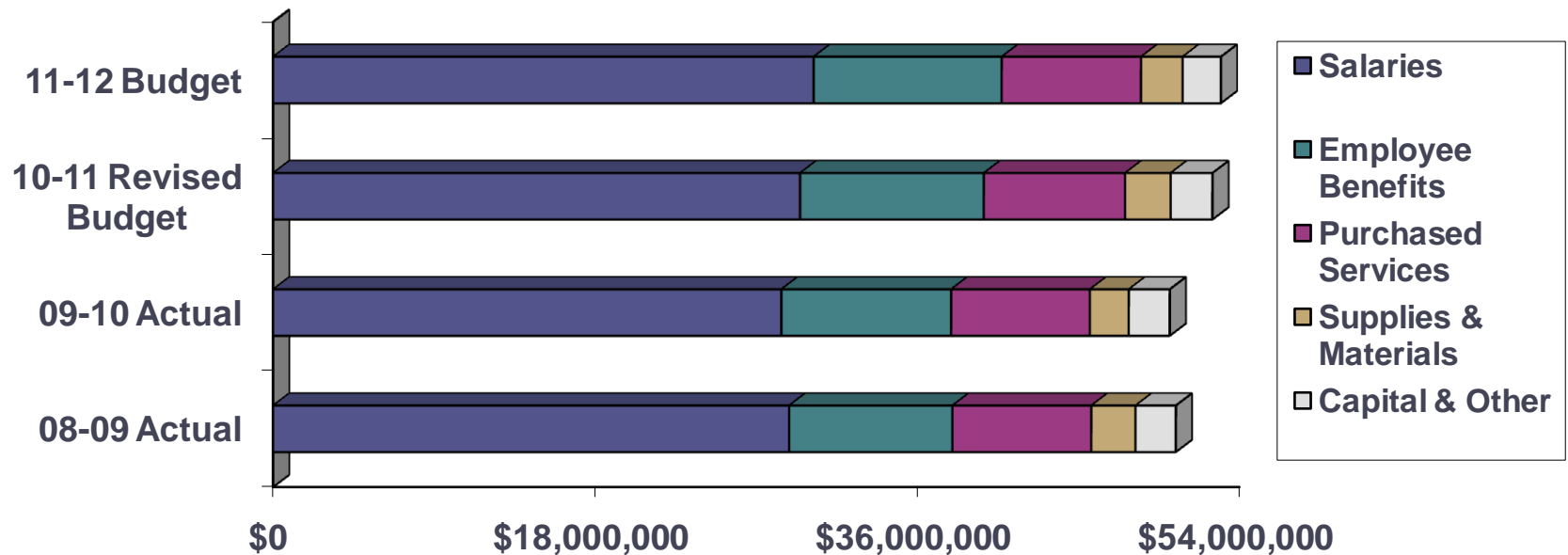

SPECIAL REVENUE FUNDS



Food Service

Fund 02



Community Service

Fund 04



ISD 877 BHM 2011-2012 FOOD SERVICE



| | | |
|----------------------------------|----------------------|------------------|
| Estimated Fund Balance @ 6/30/11 | | \$155,842 |
| Revenue | \$3,029,150 | |
| Expenditures | <u>(\$3,015,750)</u> | |
| Estimated Fund Balance @ 6/30/12 | | <u>\$169,242</u> |



ISD 877 BHM 2011-2012 FOOD SERVICE



Revenue

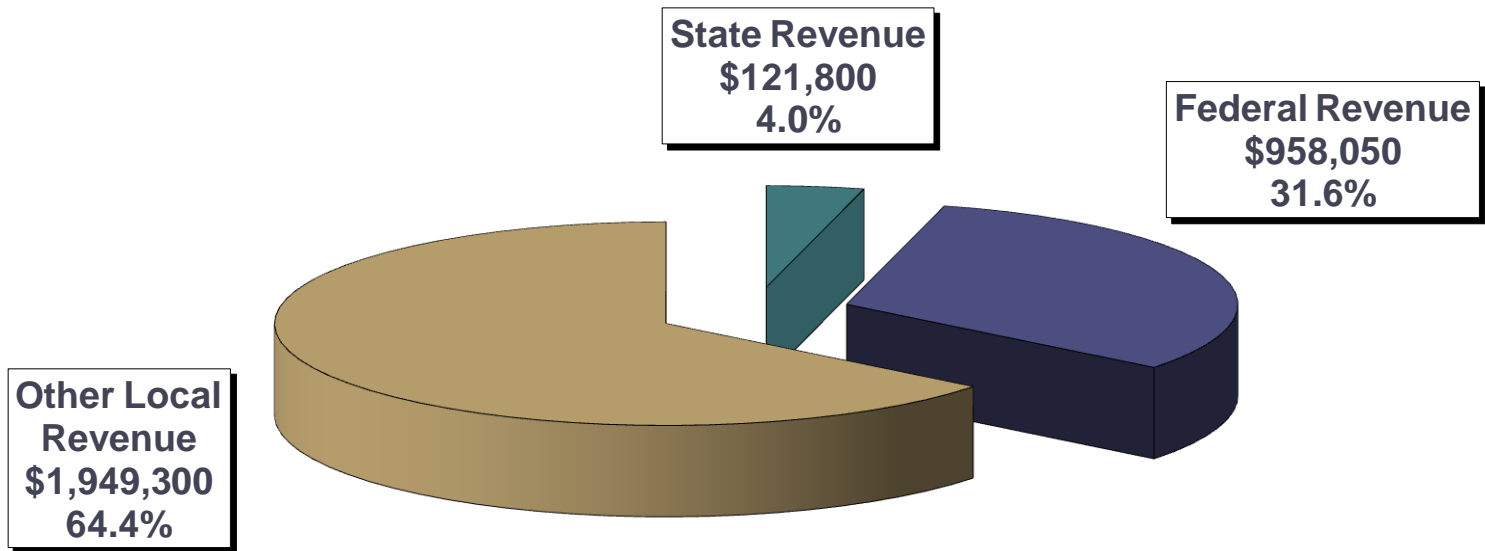

ISD 877 BHM 2011-2012 FOOD SERVICE



Expenditures

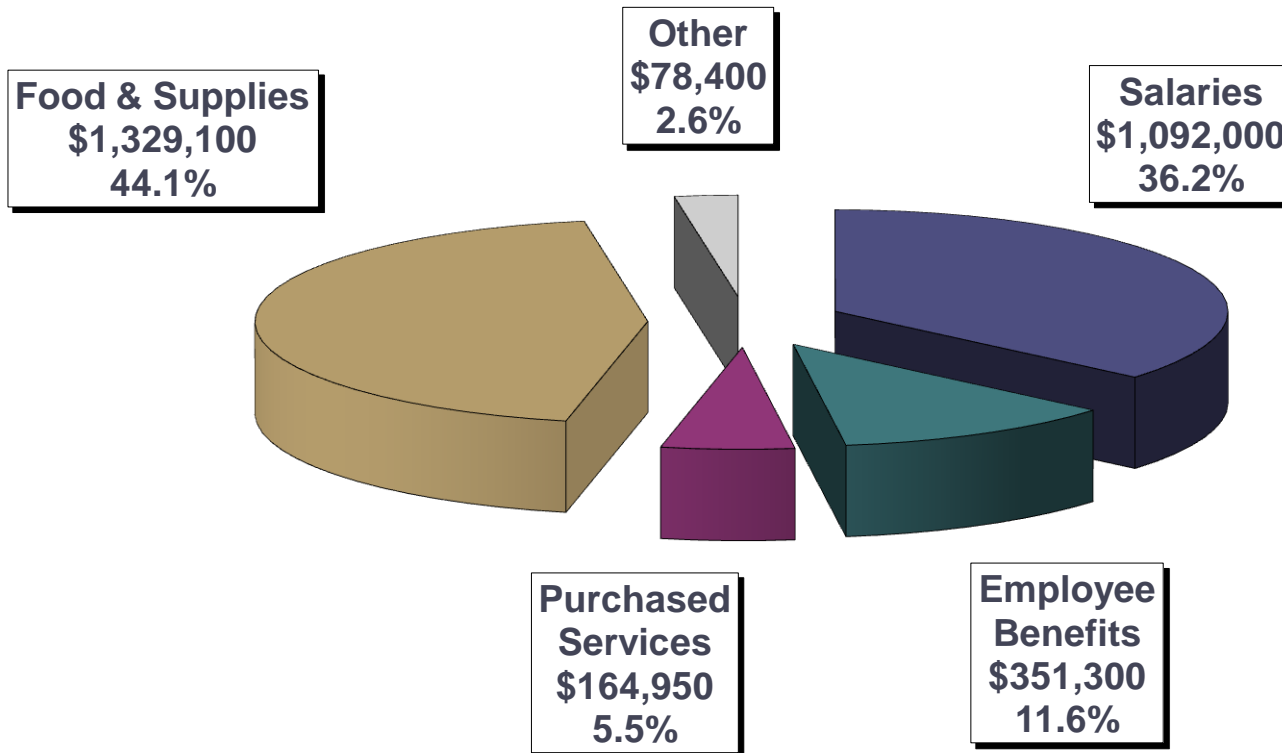

ISD 877 BHM 2011-2012 COMMUNITY SERVICE



| | | |
|-----------------------------------|----------------------|------------------|
| Estimated Fund Balance @ 6/30/11* | | \$266,864 |
| Revenue | \$3,155,582 | |
| Expenditures | <u>(\$3,144,364)</u> | |
| Estimated Fund Balance @ 6/30/12* | | <u>\$278,082</u> |

****Fund Balance includes restricted amounts for Community Ed, ECFE, School Readiness, and ABE***



ISD 877 BHM 2011-2012 COMMUNITY SERVICE



Revenue

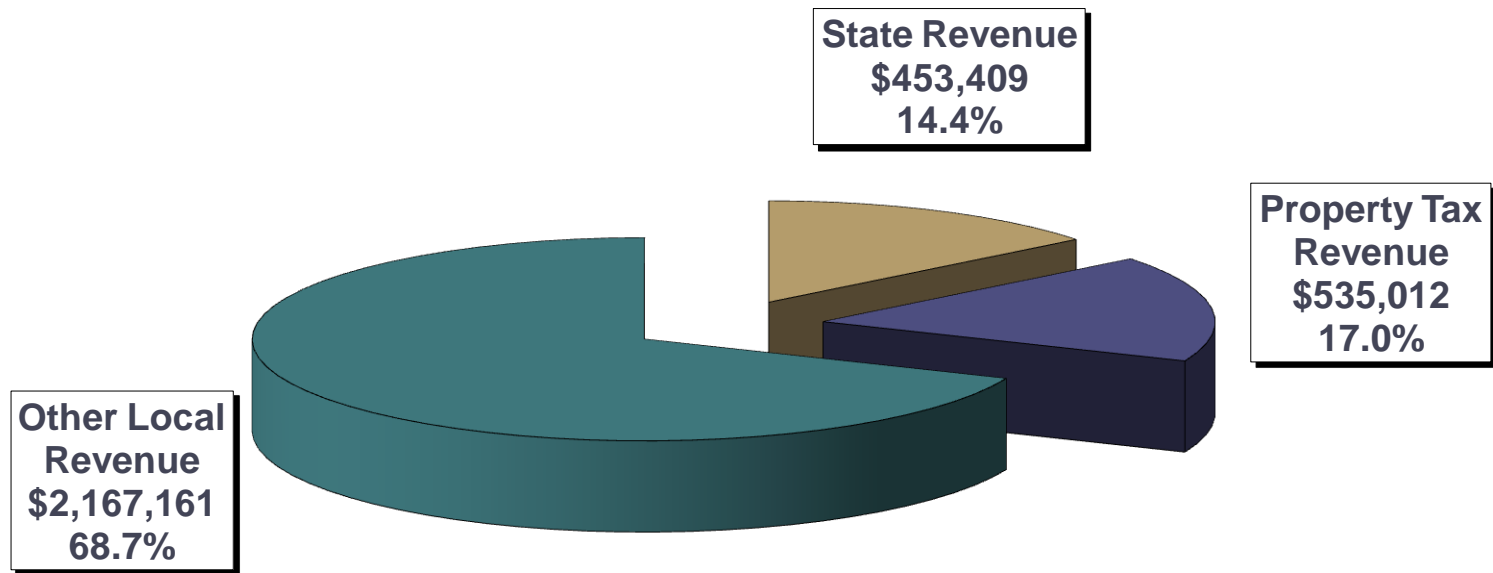

ISD 877 BHM 2011-2012 COMMUNITY SERVICE



Expenditures

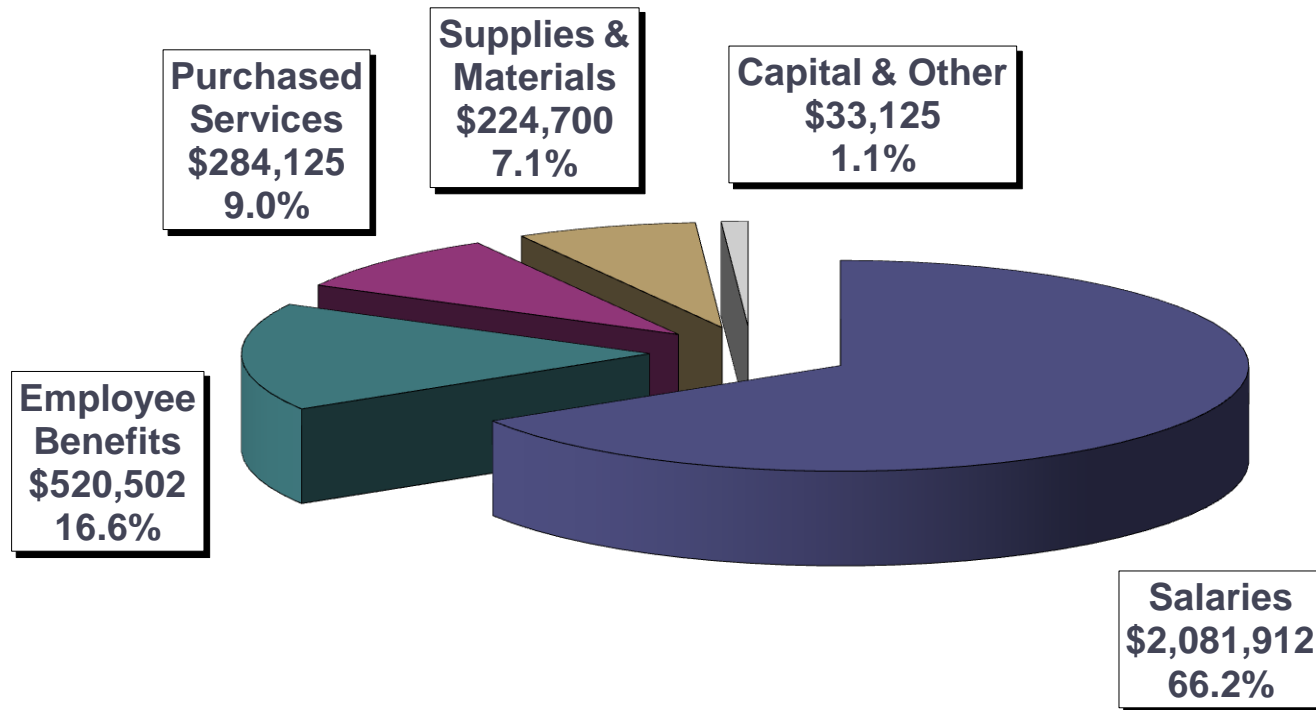

OTHER FUNDS



Debt Service

Fund 07

OPEB Trust

Fund 45

OPEB Debt Service

Fund 47



ISD 877 BHM 2011-2012 DEBT SERVICE



| | | |
|----------------------------------|----------------------|--------------------|
| Estimated Fund Balance @ 6/30/11 | | \$1,438,542 |
| Revenue | \$6,679,340 | |
| Expenditures | <u>(\$6,713,265)</u> | |
| Estimated Fund Balance @ 6/30/12 | | <u>\$1,404,617</u> |



ISD 877 BHM 2011-2012 DEBT SERVICE



Revenue

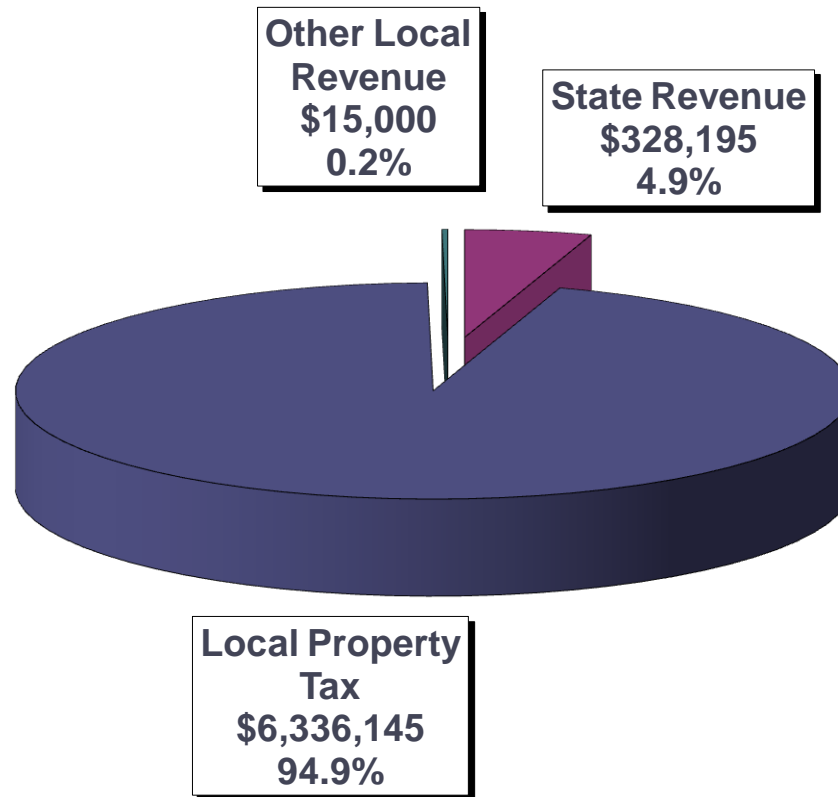

ISD 877 BHM 2011-2012 DEBT SERVICE



Expenditures

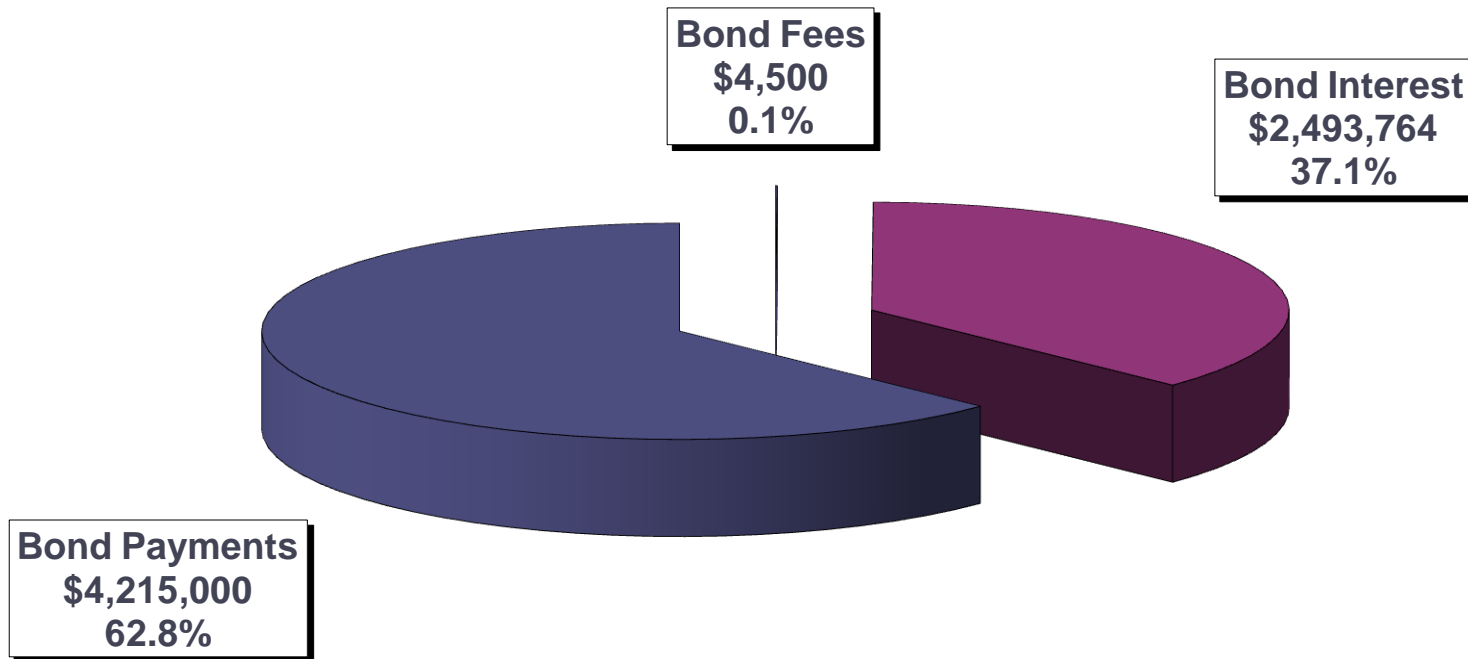

ISD 877 BHM 2011-2012 OPEB TRUST



| | | |
|----------------------------------|--------------|---------------------|
| Estimated Fund Balance @ 6/30/11 | | \$12,093,203 |
| Revenue | \$1,000,000 | |
| Expenditures | <u>(\$0)</u> | |
| Estimated Fund Balance @ 6/30/12 | | <u>\$13,093,203</u> |



ISD 877 BHM 2011-2012

OPEB TRUST



Revenue

**Change in Market
Value**
\$1,000,000
100.0%

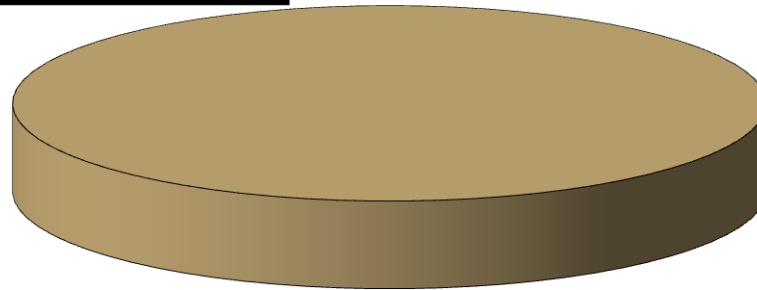

ISD 877 BHM 2011-2012 OPEB DEBT SERVICE



| | | |
|----------------------------------|--------------------|-----------------|
| Estimated Fund Balance @ 6/30/11 | | \$41,438 |
| Revenue | \$519,688 | |
| Expenditures | <u>(\$495,488)</u> | |
| Estimated Fund Balance @ 6/30/12 | | <u>\$65,638</u> |



ISD 877 BHM 2011-2012 OPEB DEBT SERVICE



Revenue

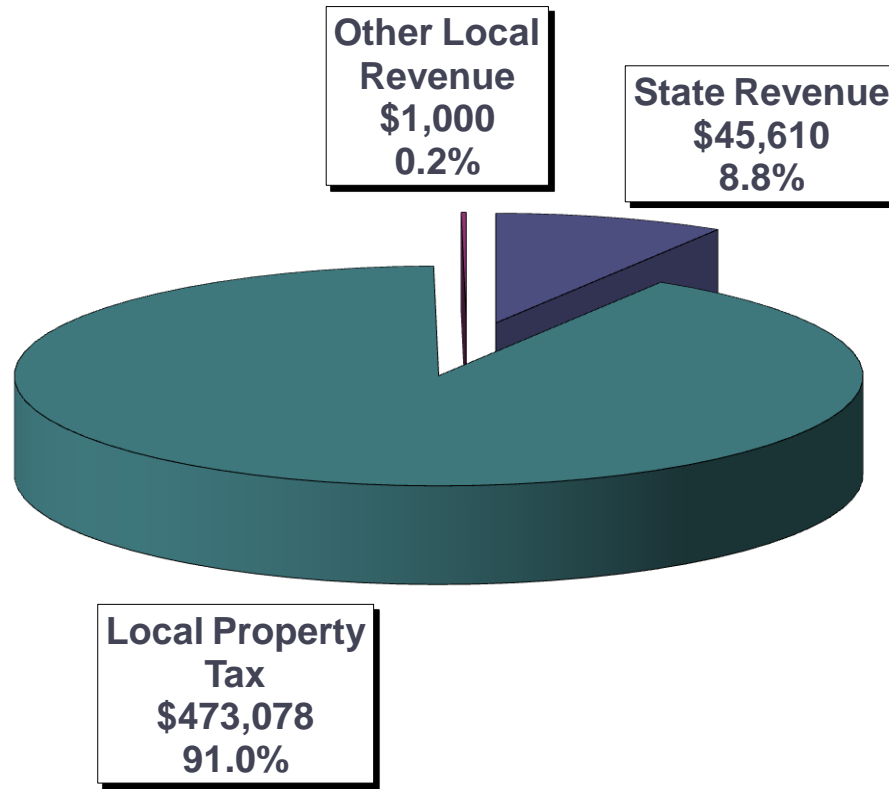

ISD 877 BHM 2011-2012 OPEB DEBT SERVICE



Expenditures

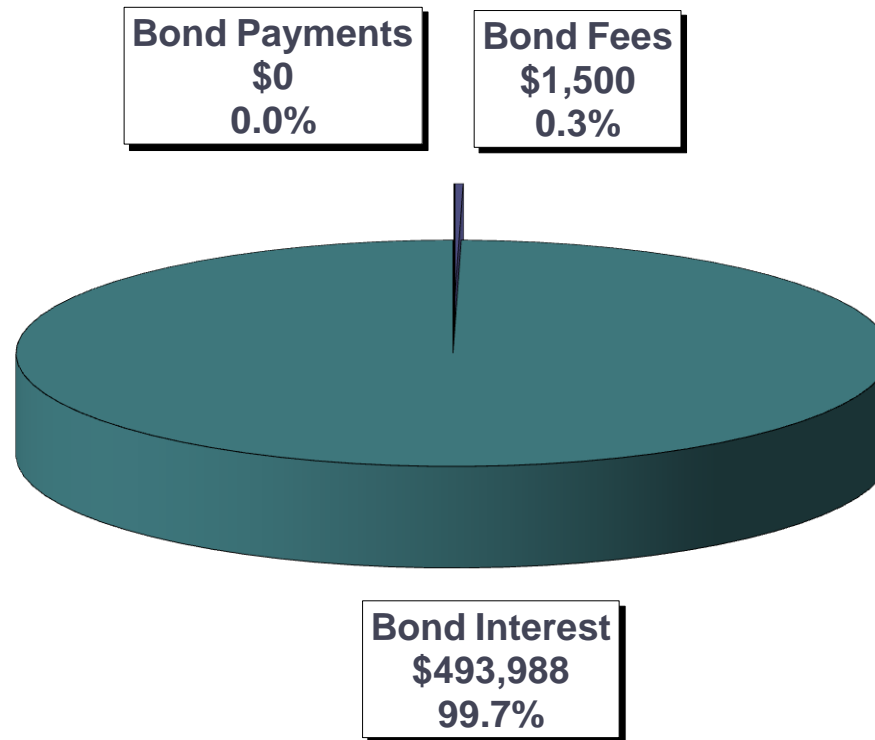

ISD 877 BHM 2011-2012 BUDGET



Questions?

