

8/16/2024 5:32:18 PM
C:\Revit Local Files\GPRSD-HS-Add-Reno-A22_bvkokurek.rvt

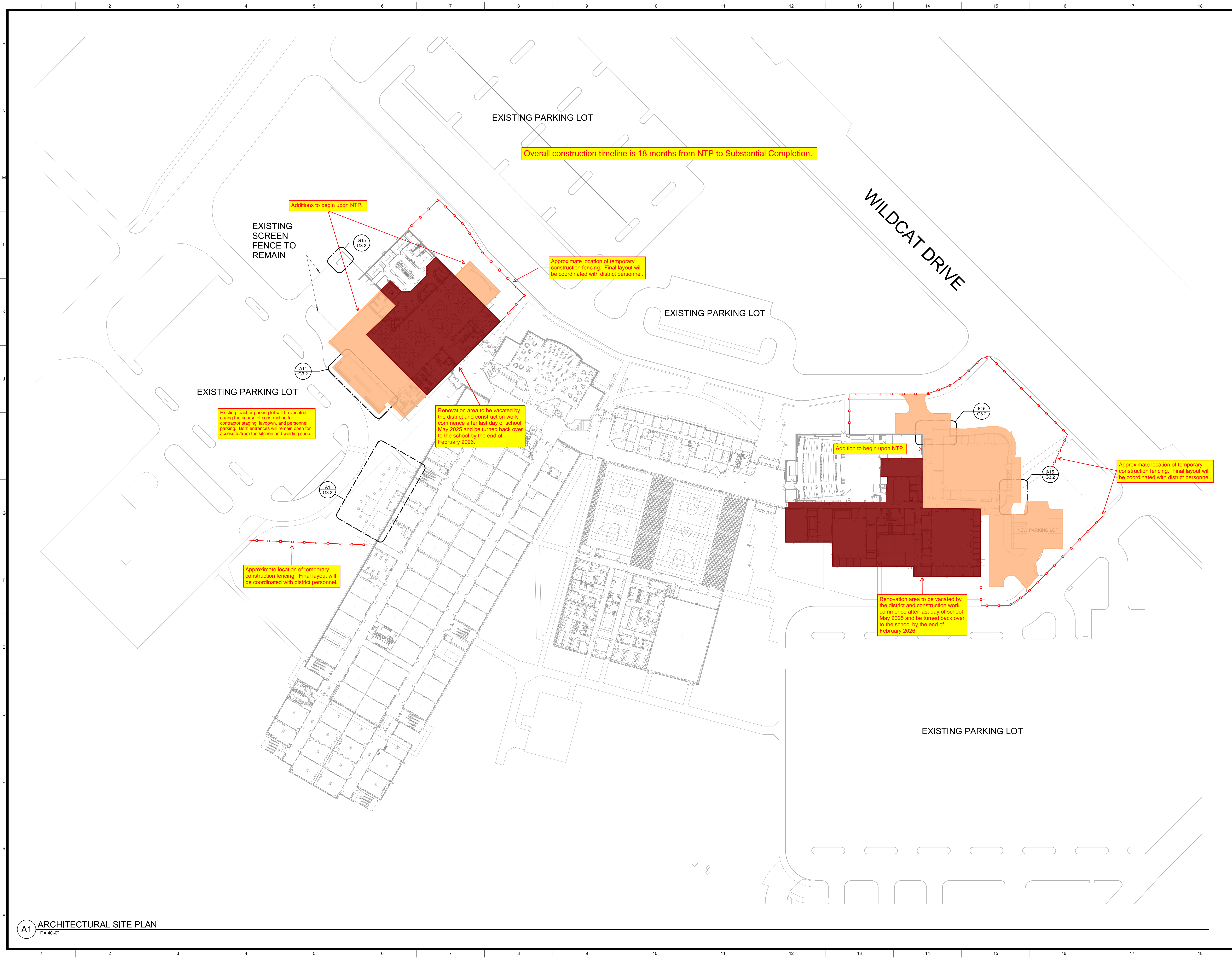

Overall construction timeline is 18 months from NTP to Substantial Completion.

Additions to begin upon NTP.

Approximate location of temporary construction fencing. Final layout will be coordinated with district personnel.

Existing teacher parking lot will be vacated during the course of construction for contractor staging, laydown, and personnel parking. Both entrances will remain open for access to/from the kitchen and welding shops.

Renovation area to be vacated by the district and construction work commence after last day of school May 2025 and be turned back over to the school by the end of February 2026.

Approximate location of temporary construction fencing. Final layout will be coordinated with district personnel.

Addition to begin upon NTP.

Approximate location of temporary construction fencing. Final layout will be coordinated with district personnel.

Renovation area to be vacated by the district and construction work commence after last day of school May 2025 and be turned back over to the school by the end of February 2026.

RMA
ARCHITECTS
 & INTERIOR DESIGNERS
 311 E. Constitution St., Ste 210
 Victoria, Texas 77901
 www.maarch.com

BRADLEY WADE KOCUREK
 REGISTERED ARCHITECT
 REGISTRATION NO. 22147
 STATE OF TEXAS

Final Plans for Bidding and Construction

HIGH SCHOOL FINE ARTS & CAFETERIA ADDITION
GREGORY-PORTLAND INDEPENDENT SCHOOL DISTRICT
 4601 WILDCAT DR., PORTLAND, TX 78374
 ©2024 BRADLEY WADE KOCUREK & ASSOCIATES

DATE ISSUED:
08-19-2024

PROJECT NUMBER:
1032-0823

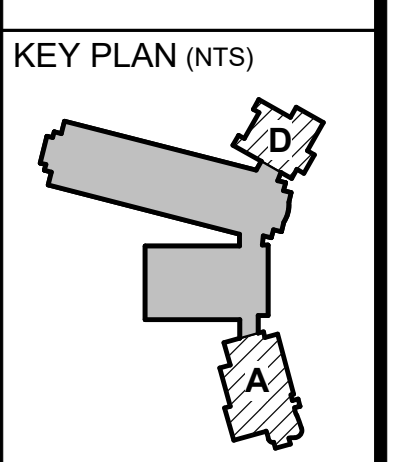

SHEET NAME
ARCHITECTURAL SITE PLAN - OVERALL

SHEET NUMBER

G3.1

A1 ARCHITECTURAL SITE PLAN
 1" = 40'-0"