



## Charter Amendment Request From

The Charter Amendment Request Form and all required documentation must be received via email ([ade.charterschools@arkansas.gov](mailto:ade.charterschools@arkansas.gov)) at the Arkansas Department of Education at least 35 days prior to the Charter Authorizing Panel meeting.

<b>Charter Name:</b>	<u>Friendship Aspire Academy Pine Bluff</u>
<b>LEA Number:</b>	<u>3544700</u>
<b>Superintendent or Director:</b>	<u>Phong Tran</u>
<b>Email:</b>	<u><a href="mailto:ptran@friendshipusa.org">ptran@friendshipusa.org</a></u>
<b>School Contact for Amendment:</b>	<u>Virginia Perry</u>
<b>Email:</b>	<u><a href="mailto:vperry@friendshipusa.org">vperry@friendshipusa.org</a></u>
<b>Phone:</b>	<u>(469) 406-3889</u>

*\*All open-enrollment amendment requests must include evidence that the request was contemporaneously sent by the applicant to the superintendent of the school district where the charter is located.*

### Type of Amendment(s) Requested

- Add a New Campus** (Must also submit the map of current location, map of proposed location, Facilities Utilization Agreement and desegregation analysis)

<b>Address:</b>	<u>700 South Main Street, Pine Bluff, AR</u>
<b>School District:</b>	<u>Pine Bluff SD</u>
<b>Grade Levels:</b>	<u>PK-3</u>
<b>Rollout Plan:</b>	<u>2021-2022: PK-1</u> <u>2022-2023: PK-2</u> <u>2023-2024: PK-3</u>
<b>Reason for New Campus:</b>	<u>We wish to keep our campuses small and the existing campus is slated for K-5 when fully enrolled. We see the need for additional early elementary seats.</u>

- Increase Enrollment Cap**

<b>Current Cap:</b>	<u>480</u>
<b>Proposed Cap:</b>	<u>880</u>

**Waivers** - The waivers currently approved for the charter are requested for the new campus.

## **1. Alternative Learning Environment**

- 6-15-1005(b)(5) – Program Requirements
- 6-18-503(a)(1)(C)(i) – Written Policy for Placement of Students with Impairment or Disability in ALE
- 6-48-101 et seq. – ALE Environment
- Standard 2-I.1 – Alternative Program
- DESE Rules Governing Student Special Needs Funding

## **2. Board of Directors**

- 6-13-615 – Election from Single-Member Zones
- 6-13-616 – Qualifications
- 6-13-619(a)(1)(A) – Meetings
- 6-13-619(c)(1)(A) – Meeting Attendance
- 6-13-619(d) – Attend Meetings Remotely
- 6-13-621 – Authority to Convey Section Lands
- 6-13-629 – Reimbursement for Training and Instruction
- 6-13-630 – Election by Zone and At-Large
- 6-13-631 – Effect of Minority Population on Election
- 6-13-634 – Size of Board
- 6-13-635 – Review and Approval of Salary Increases
- 6-14-101 et seq. – General Election Laws
- DESE Rules and Regulation Governing School Board Zones and Rezoning

## **3. Class Size and Teaching Load**

- 6-17-812 – Compensation for Exceeding Class Size and Teaching Load
- Standard 1-A.5 – Class Size and Teaching Load
- DESE Rules Governing Class Size and Teaching Load – Section 1-3

\*\*School will not exceed 20 students in kindergarten and 25 in all other grades

## **4. Gifted and Talented**

- 6-20-2208(c)(6) – Required Expenditures
- 6-42-109 – Annual Reporting
- Standard 2-G.1 – Gifted and Talented Program
- DESE Rules Governing Gifted and Talent Program Standards

## **5. Grading**

- 6-15-902(a) – Secondary Grading Scale
- 6-15-902(c)(2) – Weighted Credit

## **6. Guidance Counselor**

- 6-18-200 - Licensure
- Standard 4-E.1 – Licensure Requirements

## **7. Library Media**

- 6-25-104 – Library Media Specialist Licensure
- Standard 4-F.1 – Licensure

## **8. Personnel - Licensed**

- 6-17-114 – Daily Planning Period
- 6-17-203 – Licensed Personnel Policy Committee
- 6-17-204 – Policies Incorporated into Contracts
- 6-17-205 – Duties and organization of Licensed Committee
- 6-17-1501 et seq. – Teacher Fair Dismissal Act
- 6-17-2403 – Minimum Teacher Compensation Schedule
- DESE Rules Governing School District Requirements for Personnel Policies, Salary Schedules, Minimum Salaries and Documents Posted to District Website – Sections 4.00 – 9.00

## **9. Personnel – Classified**

- 6-17-2301 – Classified Personnel Policies
- 6-17-2303 - Classified Personnel Policy committee
- 6-17-2204 - Classified School Employee Salary Act Rules
- 6-17-201(c)(2) - Compensation schedule included in Personnel Policies
- 6-17-1701 et seq. - Public School Employees Fair Hearing Act
- 6-17-2201 - Classified School Employee Minimum Salary Act
- 6-17-2202 - Classified employee definition
- 6-17-2203 - Classified minimum salary
- 6-17-2205 - Paid breaks for classified employees
- 6-17-2206 - Highly qualified paraprofessional bonus
- 6-17-2305 - Classified Employees Personnel Policy Committee organization and duties

## **10. Principals**

- 6-17-302 – Principal Qualifications and Responsibilities
- Standard 4-C.1 – Employment of Principal
- Standard 4-C.2 – Principal Licensure

## **11. Salaries**

- 6-17-807 – Twelve-Month Contracts for Vocational Agriculture Teachers
- 6-17-919 – Warrants Void Without Valid License and Contract

## **12. School Start Date**

- 6-10-106 – Uniform Dates for Beginning and End of School Year

## **13. Superintendent**

- 6-13-109 – Superintendent Licensure
- 6-17-427 – Superintendent Mentoring Program

- Standard 4-B.1 – Employment of Full-Time Superintendent
- Standard 4-B.2 – Superintendent Licensure
- **DESE Rules Governing the Superintendent Mentoring Program**

#### **14. Teacher Licensure**

- 6-15-1004 – Qualified Teachers in Every Classroom
- 6-17-309 – Teacher Licensure Waivers
- 6-17-401 – Licensure Requirements
- 6-17-902 – Definition of Teacher
- Standard 4-D.1 – Teacher Licensure
- DESE Rules Governing Educator Licensure

# Facilities Utilization Agreement

To be completed and submitted with an amendment request to add a new campus or relocate an existing campus

Lessor (Owner): Friendship Education Foundation

Lessee (Tenant): Friendship Aspire Academy Pine Bluff

Information regarding affiliation, family ties or other relationships between the Lessor and Lessee:

There are no family ties between Friendship Education Foundation and Friendship Aspire Academy

Pine Bluff (FAAPB). Friendship Education Foundation is the CMO that works for FAAPB.

Address of Premises: 700 South Main Street, Pine Bluff, AR

Describe the present use of the facility: The structure is currently unoccupied.

Square Footage: TBD Rental Amount: TBD

Terms of Lease: TBD

**Contingency:** The terms of this agreement are contingent upon Friendship Aspire Academy Pine Bluff Charter School receiving approval by the Authorizer to operate an open-enrollment public charter school at the premises identified.

No indebtedness of any kind incurred or created by the open-enrollment public charter school shall constitute an indebtedness of the State of Arkansas or its political subdivisions and no indebtedness of the open-enrollment public charter school shall involve or be secured by the faith, credit or taxing power for the state or its political subdivisions. An open-enrollment public charter school shall not incur any debt, including lease, without the prior review and approval of the Commissioner of Education.

We affirm that the facility is, or will be prior to charter occupancy, compliant with ADE/IDEA accessibility regulations and will remain so while the charter occupies the location.

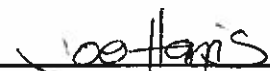
Lessee: 

By: Joe Harris Date: 04/30/2021  
Signature

Lessor: 

By: Phong Tran Date: 04/30/2021  
Signature

## Desegregation Analysis

Friendship Aspire Academy Pine Bluff (Friendship Aspire) proposes to locate its open-enrollment public charter school within the boundaries of the Pine Bluff School District, and as an open-enrollment public charter school unconfined by district boundaries, expects to obtain its students from within the boundaries of the Pine Bluff and Dollarway School Districts. As we seek to operate an open-enrollment charter school in the PBSB, Friendship Aspire School's careful review of the court orders and statutory obligations indicate that our school should not create and maintain a unitary system of desegregated in the PBSB.

Friendship Aspire understands that we are required: 1) by Ark. Code Ann. § 6-23-105 to carefully review the potential impact its opening would have upon the efforts of the Pine Bluff School District to comply with court orders and statutory obligations to create and maintain a unitary system of desegregated public schools; 2) that the granting of an open-enrollment public school charter for Friendship Aspire cannot be said to have a negative impact on the Pine Bluff and Dollarway School District's ability to comply with court orders or statutory obligations to create and maintain a unitary system of desegregated public schools; 3) Pursuant to Ark. Code Ann. § 6-23-306, that Friendship Aspire must be race-neutral and non-discriminatory in its student selection and admission processes; and 4) Ark. Code Ann. § 6-23-105 requires that Friendship Aspire's operation will not serve to hamper, delay, or in any manner negatively affect the desegregation efforts of a public school district or districts within the state.

On February 4, 2016, ADE Legal Services Staff did a desegregation analysis of Amendment request for Quest Middle School of Pine Bluff. In their memorandum to the Charter Authorizer, they cited that, "Although Ark. Code Ann. § 6-23-106 requires the authorizer to carefully analyze the impact of any new proposed charter school on the efforts of public school districts to achieve and maintain unitary systems, it does not require the authorizer to conduct an analysis of proposed amendments to an existing charter. However, Ark. Code Ann. § 6-23-106(c) states that the State Board "shall not approve any ... act or any combination of acts that hampers, delays, or in any manner negatively affects the desegregation efforts of a public school district or public school districts in this state."

Furthermore, they outlined the enrollment in the Pine Bluff and surrounding Districts of Dollarway, Watson Chapel and White Hall as follows:

Based on their analysis, ADE determined that they are "not aware of any active desegregation orders in the affected districts, and no desegregation-related opposition was received from any of the affected school districts." The board of Friendship Aspire understands that Arkansas law does not allow the authorizer to approve any public charter school that "hampers, delays, or in any manner negatively affects the desegregation efforts" of a public school district. Ark. Code Ann. § 6-23-106(c). The Supreme Court noted in *Missouri v. Jenkins*, 515 U.S. 70, 115 (1995):

[I]n order to find unconstitutional segregation, we require that plaintiffs "prove all of the essential elements of *de jure* segregation -- that is, stated simply, a current condition of segregation resulting from *intentional state action directed specifically* to the [allegedly segregated] schools." *Keyes v. School Dist. No. 1*, 413 U.S. 189, 205-206 (1973) (emphasis added). "[T]he differentiating factor between *de jure* segregation and so-called *de facto* segregation . . . is purpose or *intent* to segregate." *Id.*, at 208 (emphasis in original).

In conclusion, Friendship Aspire submits that, upon the basis of its review, neither any existing federal District Court desegregation order affecting the PBSB and the PBSSD, nor the 1989 Settlement Agreement, prohibit the State's charter school authorizer from granting a new charter for an open-enrollment public charter school in Pine Bluff or Dollarway County.

**Revenue**

<b>Operating</b>	\$ 1,354,560.00
<b>Building</b>	\$ 80,000.00
<b>Federal Grants</b>	\$ 200,000.00
<b>Food Service</b>	\$ 120,000.00
<b>Grants</b>	\$ 1,200,000.00
<b>Total</b>	\$ 2,954,560.00

Account Description	Projected Budget	Notes
SALARY	\$ 1,146,723.49	
Total	\$ 1,146,723.49	
PS PROF/TECH		
STAFF SERVICES	\$ -	
APSRC/ Title I		
INSTRUCTIONAL-SPED	\$ 40,000.00	Other related services
SUBSTITUTES	\$ 5,000.00	
CONSULTING EDUCATIONAL ASSESSMENT	\$ 77,268.80	
PROF DEVELOPMENT CERT	\$ 5,000.00	
PROF DEVELOPMENT CLASSIFI	\$ 20,000.00	
DATA PROCESSING SERVICE	\$ -	
PS PROF ACCOUNTING	\$ -	
AUDIT	\$ 40,000.00	
PS PROF LEGAL	\$ 10,000.00	
PS PROF MEDICAL	\$ -	
PS PROF OTHER	\$ -	
SOFTWARE MAIN & SUPPORT	\$ -	
TECHNOLOGY SUPPORT	\$ -	
PURCHASE SERVICE-TECH		
PS P/T OTHER P/T		
WATER/SEWER	\$ 5,000.00	
DISPOSAL/SANATATION	\$ 5,000.00	
CUSTODIAL	\$ 2,000.00	
LAWN CARE	\$ 7,000.00	
BLDG & GROUNDS	\$ 10,000.00	
EQUIPMENT & VEHICLES		
LAND & BLDGS- RENT	\$ 132,460.80	
BUS LEASE	\$ -	
PRINTER LEASE	\$ 15,000.00	
PPS CONSTRUCTION SERVICES	\$ -	
PPS OTHER-Security Officers		
FROM OTHER SOURCES		
PROPERTY INSURANCE	\$ 30,000.00	
LIABILITY INSURANCE	\$ 20,000.00	
TELEPHONE	\$ 10,000.00	
POSTAGE	\$ 500.00	
NETWORKING/INTERNET SERVI	\$ 5,000.00	
BANDWIDTH	\$ -	
ADVERTISING	\$ 2,000.00	
PRINTING & BINDING	\$ -	
SOFTWARE	\$ -	
TRAVEL CERTIFIED IN DISTRICT		
TRAVEL CERTIFIED OUT DISTRICT		



TRVL CERT OUT STATE	\$	-	
PS TRAVEL NON EMPLOYEE	\$	-	
PS TRAVEL LODGING	\$	-	
MISC PURC SVS-student uniforms	\$	-	
SVS PURCHASED LOCALLY	\$	-	
	Total	\$	441,229.60
GENERAL SUPPLIES	\$	30,000.00	
INTERIM ASSESMENTS	\$	-	
SUPPLIES 500-999.99			
CLASSROOM SUPPLIES	\$	30,000.00	
PS ACTIVITIES-SUPPLIES	\$	-	
PRINCIPAL INCENTIVE PROG.	\$	-	
Instructional Coach Incentive Program	\$	-	
Behavioral Interventionist Incentive Program	\$	-	
OFFICE SUPPLIES	\$	20,000.00	
JANTORIAL SUPPLIES	\$	20,000.00	
ACTIVITY FIELD TRIPS	\$	10,000.00	
NAT.GAS	\$	20,000.00	
ELECTRICITY	\$	60,000.00	
GASOLINE/DIESEL	\$	-	
FOOD	\$	150,000.00	Will apply for CNU reimbursement
TEXTBOOKS	\$	70,000.00	
TECHN SUPPLIES	\$	20,000.00	
SOFTWARE	\$	10,000.00	
STUDENT TECHN SUPPLIES	\$	-	
TEACHER TECH SUPPLIES	\$	20,000.00	
Tota	\$	460,000.00	
MACHINERY	\$	-	
FURNITURE & FIXTURES	\$	30,000.00	
EQUIP TECHNOLOGY HARDWARE	\$	30,000.00	
OTHER EQUIPMENT	\$	5,000.00	
	Total	\$	65,000.00
DUES AND FEES			
INTEREST	\$	-	
INDIRECT COST	\$	-	
MISC EXPENDITURES	\$	-	
FIELD TRIPS	\$	-	
REDEMPTION OF PRINCIPAL	\$	-	
PROGRAM RETURN FUNDING	\$	-	
	Total	\$	-
	Total	\$	2,112,953.09

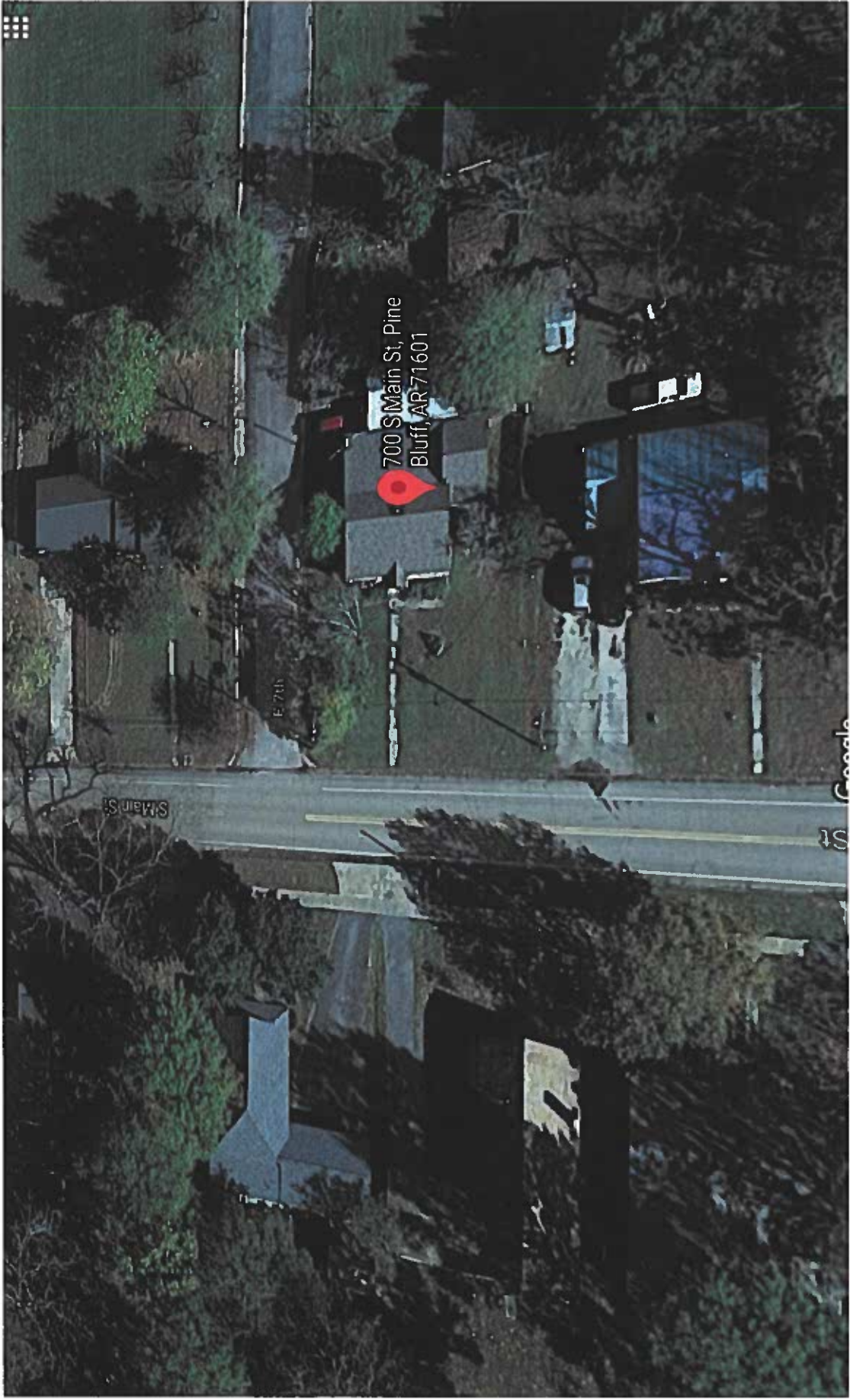

# Friendship Aspire Academy Student Demographic Percentages

Excludes PK Students

293 Total Active Students On 05/03/2021

---

## Building Gender Percentages

Gender	Gender Count	Gender Percentage
Females	149	50.85%
Males	144	49.15%
<b>Gender - Total</b>	<b>293</b>	<b>100.00%</b>

---

## Building Primary Race Percentages

Race	Race Count	Race Percentage
Asian	2	0.68%
Black	277	94.54%
Hawaii/Pacific Islander	1	0.34%
Hispanic or Latino	7	2.39%
Two or More Races	1	0.34%
White	5	1.71%
<b>Primary Race - Total</b>	<b>293</b>	<b>100.00%</b>

---

## Building Meal Status Percentages

Meal Status Code	Meal Status Count	Meal Status Percentage
01	74	25.26%
02	38	12.97%
03	33	11.26%
04	147	50.17%
Unassigned	1	0.34%
<b>Meal Status - Total</b>	<b>293</b>	<b>100.00%</b>

---

**Friendship Aspire Academy at Pine Bluff**  
**Friendship Aspire Academy**  
**ENROLLMENT REPORT**  
**Enrollment Date: May 3, 2021**

Enrollment Count		01	02	03	KF	Race Totals
Asian	Females	1		1		2
	<b>Gender Totals</b>	<b>1</b>		<b>1</b>		<b>2</b>
Black	Females	51	38	16	37	142
	Males	44	39	16	36	135
	<b>Gender Totals</b>	<b>95</b>	<b>77</b>	<b>32</b>	<b>73</b>	<b>277</b>
Hawaiian/Pacific Islander	Females				1	1
	<b>Gender Totals</b>				<b>1</b>	<b>1</b>
Hispanic	Females				1	1
	Males		2	2	2	6
	<b>Gender Totals</b>		<b>2</b>	<b>2</b>	<b>3</b>	<b>7</b>
Two or More	Females		1			1
	<b>Gender Totals</b>		<b>1</b>			<b>1</b>
White	Females				2	2
	Males	1	1		1	3
	<b>Gender Totals</b>	<b>1</b>	<b>1</b>		<b>3</b>	<b>5</b>
<b>Grade Totals</b>		<b>97</b>	<b>81</b>	<b>35</b>	<b>80</b>	<b>293</b>



# CITY OF PINE BLUFF

*Office of the Mayor*

Shirley M. Washington

February 4, 2021

Dear Members of the Arkansas Authorizing Charter Panel:

It is with great pleasure that I offer this letter in support of Friendship Aspire and its plans in the City of Pine Bluff. Friendship Aspire currently operates two schools in the community, where children and teens are being offered high quality learning and college preparation. Not only are countless parents and students delighted with this educational experience, but I am also pleased with the outstanding services that I have witnessed upon numerous visits.

Because of this, we strongly support the growth of Friendship Aspire, especially the development of a Pre K-3 school. There is a high demand for early education in the community, and Pine Bluff parents welcome any opportunity that fulfills this need, including high performing charter schools. Friendship Aspire is also a welcome resource because of the trust it has garnered through ongoing community engagement and educational achievement.

In addition to fulfilling community needs, a downtown school would also advance the city's ongoing efforts to revitalize the area and support the economic development goals of other community partners, such as Go Forward Pine Bluff. Furthermore, its proximity to the new Pine Bluff/Jefferson County Library and the Arts and Science Center will make the school an ideal location for creativity and innovative learning.

Friendship's education model, which focuses on reading fundamentals, will also contribute long-term benefits to the city. Research shows that developing strong reading skills among young people can build a stronger workforce. This is critical as Pine Bluff seeks to attract more jobs and economic opportunities to the city.

We look forward to the exciting potential that Friendship Aspire represents, and we hope that your company will support these life-changing endeavors.

Sincerely,

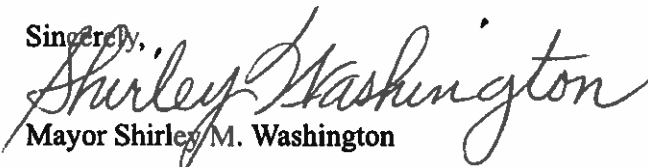
  
Mayor Shirley M. Washington