



# Quote

06/20/2025

**To:**  
Rock Island Milan School District  
#41  
Beth McKenna  
2000 7th Avenue  
Rock Island, IL 61201  
(309) 793-5900 10220 (Contact)  
(309) 429-2070 (Cell)  
beth.mackenna@rimsd41.org  
Director of Nutrition Services  
Project Code: 35404

**Project:**  
RIMSD41 - Rock Island High School  
- Milk Cooler Bid  
1400 25th Avenue  
Rock Island, IL 61201

**From:**  
Cook's Direct, Inc.  
Mike Ingargiola  
Strategic Account Manager  
2250 75th St  
Suite 200  
Woodridge, IL 60517  
(630) 566-9924  
mingargiola@cooksdirect.com

Job Reference Number: 61201-3

**Sourcewell Account #60955 / 063022-COK**

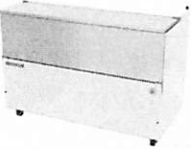
Item	Qty	Description	Sell	Sell Total
1	1 ea	<b>MILK COOLER</b>  Beverage Air Model No. SM58HC-W School Milk Cooler, cold wall, normal temperature, 58"W x 30-5/8"D x 41-1/8"H, 22.63 cu. ft., single access, flat top carton capacities, (16) 13" x 13" x 11" or (10) 19" x 13" x 11" case capacity, self-latching doors/lids with safety bumpers, cylinder lock, wire floor racks, floor drain, electronic control, manual defrost, galvanized steel interior with stainless steel floor, white exterior, R290 Hydrocarbon refrigerant, 1/3 HP, cULus, UL EPH Classified, UL-Sanitation	\$3,273.84	\$3,273.84
	1 ea	7 year parts & labor and 7 year compressor warranty (excludes maintenance items)		
	1 ea	115v/60/1-ph, 2.2 amps, cord with NEMA 5-15P		
	1 ea	4" Heavy duty casters, (2) with brakes, standard		
	1 ea	FREE — Lift gate delivery, per load (Required if there is no dock at the location or if there is no forklift onsite to take the unit(s) off the truck)		
<b>ITEM TOTAL:</b>				<b>\$3,273.84</b>

Item	Qty	Description	Sell	Sell Total
2	1 ea	<b>MILK COOLER</b> Beverage Air Model No. SM49HC-W School Milk Cooler, cold wall, normal temperature, 49"W x 30-5/8"D x 41-1/8"H, 20.32 cu. ft., single access, flat top carton capacities, (12) 13" x 13" x 11" or (8) 19" x 13" x 11" case capacity, self-latching doors/lids with safety bumpers, cylinder lock, wire floor racks, floor drain, electronic control, manual defrost, galvanized steel interior with stainless steel floor, white exterior, R290 Hydrocarbon refrigerant, 1/3 HP, cULus, UL EPH Classified, UL-Sanitation	\$2,935.16	\$2,935.16
	1 ea	7 year parts & labor and 7 year compressor warranty (excludes maintenance items)		
	1 ea	115v/60/1-ph, 2.2 amps, cord with NEMA 5-15P		
	1 ea	4" Heavy duty casters, (2) with brakes, standard		
	1 ea	FREE — Lift gate delivery, per load (Required if there is no dock at the location or if there is no forklift onsite to take the unit(s) off the truck)		
<b>ITEM TOTAL:</b>				<b>\$2,935.16</b>
Merchandise				\$6,209.00
Total				\$6,209.00

Prices Good Until: 08/08/2025

**Sourcewell Account #60955 / 063022-COK**

#### Quote Approval

By affixing their signature to this document, the undersigned hereby affirms the accuracy of the provided information. The signee acknowledges that all utilities and dimensions specified are compatible with the operational requirements at the designated facility. Furthermore, it is confirmed that the listed equipment is suitable for passage through doorways, hallways, and vestibules from the receiving area to the kitchen.

In the event of equipment returns attributable to inaccuracies in utilities or measurements, the signee acknowledges the imposition of a manufacturer restocking fee, in addition to the applicable return shipping charges.

#### Receiving Policy and Guidelines:

Prior to signing for the delivery, it is crucial to thoroughly inspect and count all cartons. Note any shortages, damages, or problems on the delivery receipt. In case of visible damage, refuse damaged boxes by checking for crushed corners, wetness, or punctures. If the delivery includes equipment, inspect all parts before signing.

If a full inspection is not possible, please make a note on the bill of lading that you will inspect at a later time (within 24 hours of receipt).

For refused shipments, the customer is responsible for full freight charges and applicable fees in both directions, unless the refusal is due to shipment damage or a shipping error made by CooksDirect.com.

Most items are eligible for return within a 30-day period from the customer's receipt of the shipment. Depending on the manufacturer, a restocking fee of 15% to 50% may be applicable. Return freight charges may also apply based on the manufacturer's policy. For inquiries regarding specific return policies for a particular manufacturer or product, kindly reach out to our Customer Service team at 1-866-506-3048 or via email at [customerservice@cooksdirect.com](mailto:customerservice@cooksdirect.com).

Please review the following criteria for returning an order:

1. Returned items must be unused, undamaged, and returned intact with original materials.
2. Special ordered or custom items cannot be returned.

Returns must be initiated within the first 30 days of receipt. Orders exceeding the 30-day return window are not eligible for returns through Cook's Direct. For product issues, please contact the manufacturer, as most large equipment is covered by a 1-year warranty.

#### **Shipping & Delivery Information:**

To ensure your order is processed in a timely manner please provide the following information along with your signature:

**Delivery Address**

**Contact Name:**

**Phone Number:**

**Receiving Hours:**

**Receiving Dock Onsite (Y/N):**

(If there is no dock onsite, additional fees for lift gate service may apply)

Note: large/oversized items may deliver on a full sized semi truck. If your receiving area cannot accommodate a full sized truck please notify your sales or sales support representative.

**Forklift/Pallet Jack Onsite (Y/N):**

Acceptance: \_\_\_\_\_ Date: \_\_\_\_\_

Printed Name: \_\_\_\_\_

Project Grand Total: \$6,209.00



# BEVERAGE-AIR

Project: _____	AIA# _____
Item: _____	
Location: _____	SIS# _____
Approved: _____	

**SM58HC SINGLE ACCESS, COLD WALL: SCHOOL MILK SERIES**

## SCHOOL MILK COLD WALL COOLER

SM58HC Single Access Cooler  
Hydrocarbon Series

MODEL:  
SM58HC-W

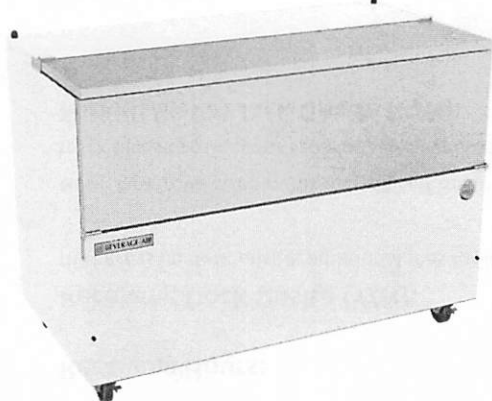

**7 Year Parts/Labor Warranty**  
**7 Year Compressor Warranty**

### CABINET CONSTRUCTION

- White coated steel exterior
- Interior features a one-piece, stainless steel back, front, floor with galvanized side walls for maximum milk crate support
- Stainless steel lids, hinged door and door latches
- Full electronic control
- Heavy-duty epoxy coated steel wire floor racks standard
- Floor drain is centrally located for easy cleaning, connecting to drain hose with hose adapter
- Flexible compression door gaskets, ensures a tight seal
- Self-latching doors/lids with safety bumpers
- Exterior thermometer
- Cylinder lock
- 4" Heavy-duty plate casters (2 with locks)
- Cold wall milk coolers are designed to hold product temperature during service. Product should be removed at the end of service and moved to long-term, refrigerated storage

### OPTIONS & ACCESSORIES

- Stainless steel interior on white models -02
- Corner bumpers
- Cafeteria tray slides
- Graphics

### REFRIGERATION SYSTEM

- Uses environmentally friendly, energy efficient R290 refrigerant, and meets all regulatory requirements for CARB, SNAP, DOE & more
- Maintains product temperature between 36°F to 40°F



  
Please verify qualifying units by visiting:  
[www.energystar.gov/cfs](http://www.energystar.gov/cfs)

3779 Champion Blvd., Winston-Salem, NC 27105  
1-888-845-9800 Fax: 1-336-245-6453  
Beverage-Air.com Sales@bevair.com



# BEVERAGE-AIR

MODEL	SM58HC-W
<b>EXTERNAL DIMENSIONAL DATA</b>	
Width Overall (in)	58"
Depth Overall (in)	30 5/8"
Height Overall with Casters (in)	41 1/8"
Number of Lids/Doors	Single Access
Depth with Door Open 90° (in)	45 1/2"
<b>INTERNAL DIMENSIONAL DATA</b>	
NET Capacity (cubic ft.)	22.63
Internal Width Overall (in)	55"
Internal Depth Overall (in)	27"
Internal Height Overall (in)	25 3/4"
<b>CASE CAPACITY</b>	
13" X 13" X 11"	16
19" X 13" X 11"	10
<b>ELECTRICAL DATA</b>	
Full Load Amperes	2.2
Voltage	115/60/1
Nema Plug (8' cord)	5-15P
<b>REFRIGERATION DATA</b>	
Horsepower	1/3
Capacity (BTU/Hr)	1434
Heat Rejection (BTU/Hr)	2151
Charge (lbs/grams/ounces)	0.1656 / 75 / 2.65
<b>SHIPPING DATA</b>	
Gross Weight	376 lbs
Height - Crated	48"
Width - Crated	61"
Depth - Crated	34"

We reserve the right to change specifications and product design without notice. Such revisions do not entitle the buyer to corresponding changes, improvements, additions or replacements for previously purchased equipment. Dimensional tolerances +/- 1/4". Metric dimensions (MM).

## School Milk Cooler - Single Access

Model: SM58HC-W

### Model Views

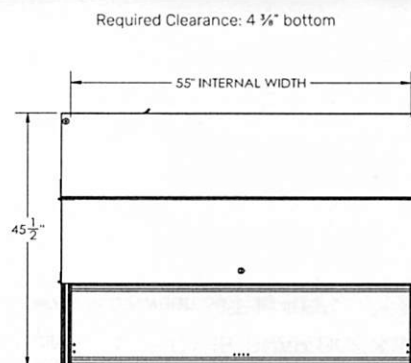

### PLAN VIEW

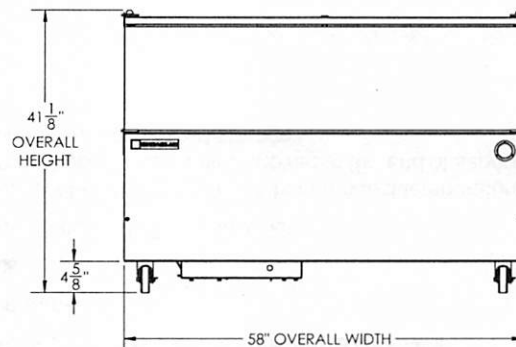

### ELEVATION VIEW

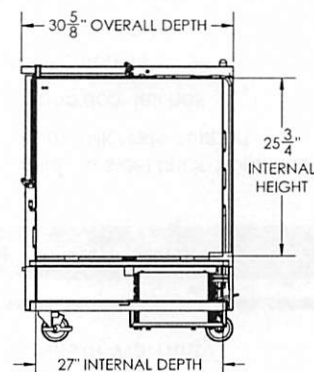

### SIDE VIEW

### ELECTRICAL CONNECTION



115/60/1  
NEMA 5-15P

Unit pre-wired at factory  
and include 8' long cord  
and plug set.

3779 Champion Blvd., Winston-Salem, NC 27105 1-888-845-9800 Fax: 1-336-245-6453 Beverage-Air.com Sales@bevair.com







# BEVERAGE-AIR

Project: _____	AIA# _____
Item: _____	SIS# _____
Location: _____	
Approved: _____	

**SM49HC SINGLE ACCESS, COLD WALL: SCHOOL MILK SERIES**

## SCHOOL MILK COLD WALL COOLER SM49HC Single Access Cooler Hydrocarbon Series

**MODEL:  
SM49HC-W**

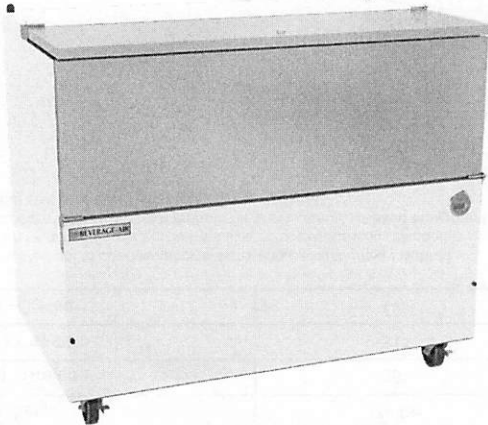

**7 Year Parts/Labor Warranty  
7 Year Compressor Warranty**

### CABINET CONSTRUCTION

- White coated steel exterior
- Interior features a one-piece, stainless steel back, front, floor with galvanized side walls for maximum milk crate support
- Stainless steel lids, hinged door and door latches
- Self-latching doors/lids with safety bumpers
- Full electronic control
- Heavy-duty epoxy coated steel wire floor racks standard
- Floor drain is centrally located for easy cleaning and connecting to drain hose with hose adapter
- Flexible compression door gaskets, ensures a tight seal
- Exterior thermometer
- Cylinder lock
- 4" Heavy-duty plate casters (2 with locks)
- Cold wall milk coolers are designed to hold product temperature during service. Product should be removed at the end of service and moved to long-term, refrigerated storage

### OPTIONS & ACCESSORIES

- Stainless steel interior on white models -02
- Corner bumpers
- Cafeteria tray slides
- Graphics

### REFRIGERATION SYSTEM

- Uses environmentally friendly, energy efficient R290 refrigerant, and meets all regulatory requirements for CARB, SNAP, DOE & more
- Maintains product temperature between 36°F to 40°F



  
Please verify qualifying units by visiting:  
[www.energystar.gov/cfs](http://www.energystar.gov/cfs)

3779 Champion Blvd., Winston-Salem, NC 27105  
1-888-845-9800 Fax: 1-336-245-6453  
[Beverage-Air.com](http://Beverage-Air.com) [Sales@bevair.com](mailto:Sales@bevair.com)



# BEVERAGE-AIR

MODEL	SM49HC-W
<b>EXTERNAL DIMENSIONAL DATA</b>	
Width Overall (in)	49"
Depth Overall (in)	30 <sup>5</sup> / <sub>8</sub> "
Height Overall with Casters (in)	41 <sup>1</sup> / <sub>8</sub> "
Number of Lids/Doors	Single Access
Depth with Door Open 90° (in)	45 <sup>1</sup> / <sub>2</sub> "
<b>INTERNAL DIMENSIONAL DATA</b>	
NET Capacity (cubic ft.)	20.32
Internal Width Overall (in)	46"
Internal Depth Overall (in)	27"
Internal Height Overall (in)	25 <sup>3</sup> / <sub>4</sub> "
<b>CASE CAPACITY</b>	
13" X 13" X 11"	12
19" X 13" X 11"	8
<b>ELECTRICAL DATA</b>	
Full Load Amperes	2.2
Voltage	115/60/1
Nema Plug (8' cord)	5-15P
<b>REFRIGERATION DATA</b>	
Horsepower	1/3
Capacity (BTU/Hr)	1367
Heat Rejection (BTU/Hr)	2050.5
Charge (lbs/grams/ounces)	0.1764 / 80 / 2.82
<b>SHIPPING DATA</b>	
Gross Weight - Crated	338 lbs
Height - Crated	48"
Width - Crated	52"
Depth - Crated	34"

We reserve the right to change specifications and product design without notice. Such revisions do not entitle the buyer to corresponding changes, improvements, additions or replacements for previously purchased equipment. Dimensional tolerances +/- 1/4". Metric dimensions (MM).

## School Milk Cooler - Single Access

Model: SM49HC-W

### Model Views

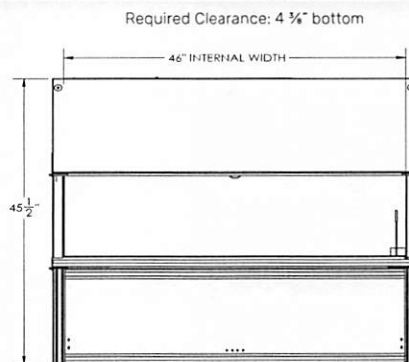

### PLAN VIEW

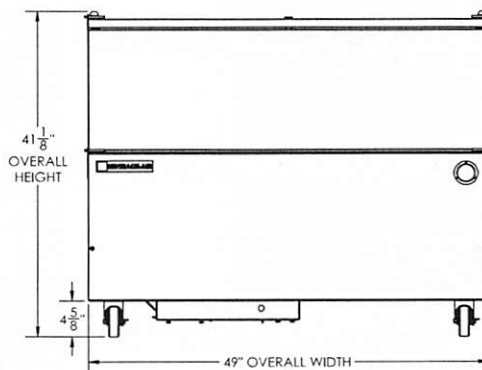

### ELEVATION VIEW

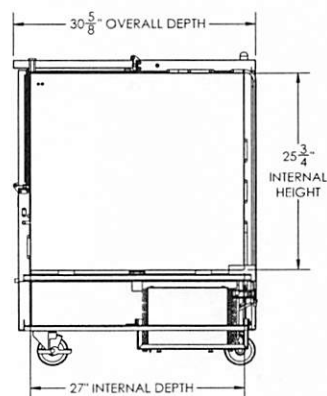

### SIDE VIEW

### ELECTRICAL CONNECTION



115/60/1  
NEMA 5-15P

Unit pre-wired at factory  
and include 8' long cord  
and plug set.



3779 Champion Blvd., Winston-Salem, NC 27105 1-888-845-9800 Fax: 1-336-245-6453 Beverage-Air.com Sales@bevair.com

